

**LSI-R...**

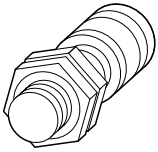

- LSI-R8S-F1-LD
- LSI-R12M-F2-LD
- LSI-R12P-F2-LD
- LSI-R12P-NF4-LD
- LSI-R18M-F5-LD
- LSI-R18P-F5-LD
- LSI-R18P-NF8-LD
- LSI-R30M-F10-LD
- LSI-R30P-F10-LD
- LSI-R30P-NF15-LD

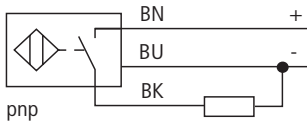

- LSI-R12P-F2-LA
- LSI-R18P-F5-LA
- LSI-R30P-F10-LA

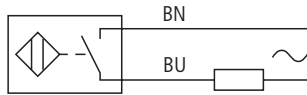

- LSI-Q40P-F20-CD
- LSI-Q40P-NF40-CD

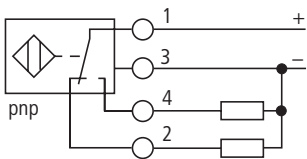

**LSI-Q40P-...-PD**

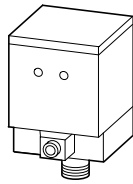

- LSI-R8S-F1-PD
- LSI-R8S-NF3-PD
- LSI-R12M-F2-PD
- LSI-R12M-NF4-PD
- LSI-R18M-F5-PD
- LSI-R18M-NF8-PD
- LSI-R30M-F10-PD
- LSI-R30M-NF15-PD
- LSI-Q40P-F20-PD
- LSI-Q40P-NF35-PD

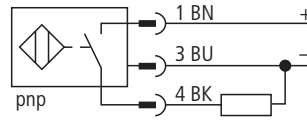

- LSI-Q40P-F20-CA
- LSI-Q40P-NF35-CA

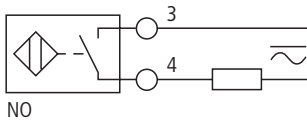

BN	braun	brown	marron	marrone	marrón	каричевый
BU	blau	blue	bleu	azzurro	azul	голубой
BK	schwarz	black	noir	nero	negro	чёрный

**LSI-Q40P-...-C...**

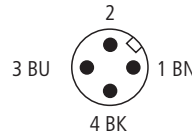
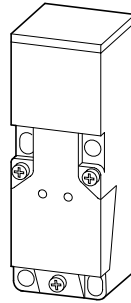

**Lebensgefahr durch elektrischen Strom!**  
 Nur Elektrofachkräfte und elektrotechnisch unterwiesene Personen dürfen die im Folgenden beschriebenen Arbeiten ausführen.

**Electric current! Danger to life!**

Only skilled or instructed persons may carry out the following operations.

**Tension électrique dangereuse !**

Seules les personnes qualifiées et averties doivent exécuter les travaux ci-après.

**Tensione elettrica: Pericolo di morte!**

Solo persone abilitate e qualificate possono eseguire le operazioni di seguito riportate.

**¡Corriente eléctrica! ¡Peligro de muerte!**

El trabajo a continuación descrito debe ser realizado por personas cualificadas y advertidas.

**Электрический ток! Опасно для жизни!**

Только специалисты или проинструктированные лица могут выполнять следующие операции.

**触电危险!**

只允许专业人员 and 受过专业训练的人员进行下列工作。

	$S_n$ mm	$U_e$ V ---	$U_e$ V ~ 50/60 Hz	$M$ Nm
LSI-R8S-F1-LD	1.5	10 – 30	–	10
LSI-R8S-F1-PD	1.5	10 – 30	–	10
LSI-R8S-NF3-PD	3	10 – 30	–	10
LSI-R12M-F2-LD	2	10 – 30	–	10
LSI-R12M-F2-PD	2	10 – 30	–	10
LSI-R12M-NF4-PD	4	10 – 30	–	10
LSI-R12P-F2-LA	2	–	20 – 250	1
LSI-R12P-F2-LD	2	10 – 30	–	1
LSI-R12P-NF4-LD	4	10 – 30	–	1
LSI-R18M-F5-LD	5	10 – 30	–	25
LSI-R18M-F5-PD	5	10 – 30	–	25
LSI-R18M-NF8-PD	8	10 – 30	–	25
LSI-R18P-F5-LA	5	–	20 – 250	2
LSI-R18P-F5-LD	5	10 – 30	–	2
LSI-R18P-NF8-LD	8	10 – 30	–	2
LSI-R30M-F10-LD	10	10 – 30	–	90
LSI-R30M-F10-PD	10	10 – 30	–	90
LSI-R30M-NF15-PD	15	10 – 30	–	90

	$S_n$ mm	$U_e$ V ---	$U_e$ V ~ 50/60 Hz	$M$ Nm
LSI-R30P-F10-LA	10	–	20 – 250	5
LSI-R30P-F10-LD	10	10 – 30	–	5
LSI-R30P-NF15-LD	15	10 – 30	–	5
LSI-Q40P-F20-CA	20	–	20 – 250	–
LSI-Q40P-F20-CD	20	10 – 65	–	–
LSI-Q40P-F20-PD	20	10 – 30	–	–
LSI-Q40P-NF35-CA	35	–	20 – 250	–
LSI-Q40P-NF35-PD	35	10 – 30	–	–
LSI-Q40P-NF40-CD	40	10 – 65	–	–

LSI-R.....-L...

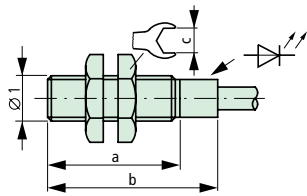

LSI-R.....-PD

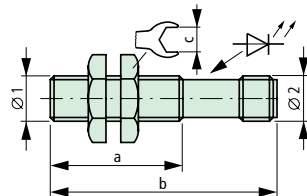

	a mm	b mm	c mm	Ø1	Ø2
LSI-R8S-F1-LD	40	42	13	M8 × 1	–
LSI-R8S-F1-PD	40	57	13	M8 × 1	M12 × 1
LSI-R8S-NF3-PD	40	57	13	M8 × 1	M12 × 1
LSI-R12M-F2-LD	40	50	17	M12 × 1	–
LSI-R12M-F2-PD	36	52	17	M12 × 1	M12 × 1
LSI-R12M-NF4-PD	36	52	17	M12 × 1	M12 × 1
LSI-R12P-F2-LA	40	60	17	M12 × 1	–
LSI-R12P-F2-LD	40	60	17	M12 × 1	–
LSI-R12P-NF4-LD	40	60	17	M12 × 1	–
LSI-R18M-F5-LD	45	50	24	M18 × 1	–
LSI-R18M-F5-PD	36	52	24	M18 × 1	M12 × 1
LSI-R18M-NF8-PD	36	52	24	M18 × 1	M12 × 1
LSI-R18P-F5-LA	45	50	24	M18 × 1	–
LSI-R18P-F5-LD	45	50	24	M18 × 1	–
LSI-R18P-NF8-LD	45	50	24	M18 × 1	–
LSI-R30M-F10-LD	55	60	36	M30 × 1.5	–
LSI-R30M-F10-PD	46	62	36	M30 × 1.5	M12 × 1
LSI-R30M-NF15-PD	46	62	36	M30 × 1.5	M12 × 1
LSI-R30P-F10-LA	50	60	36	M30 × 1.5	–
LSI-R30P-F10-LD	50	60	36	M30 × 1.5	–
LSI-R30P-NF15-LD	50	60	36	M30 × 1.5	–

LSI-Q40P-F20-PD  
LSI-Q40P-NF35-PD

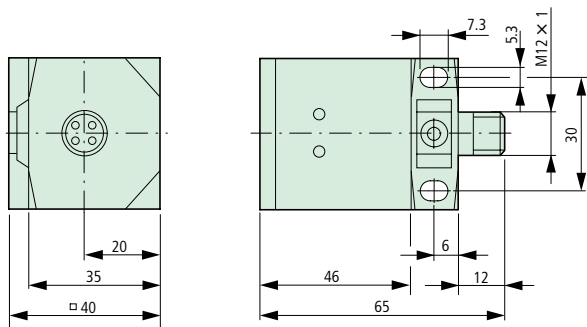

LSI-Q40P-F20-CA  
LSI-Q40P-F20-CD  
LSI-Q40P-NF35-CA  
LSI-Q40P-NF40-CA

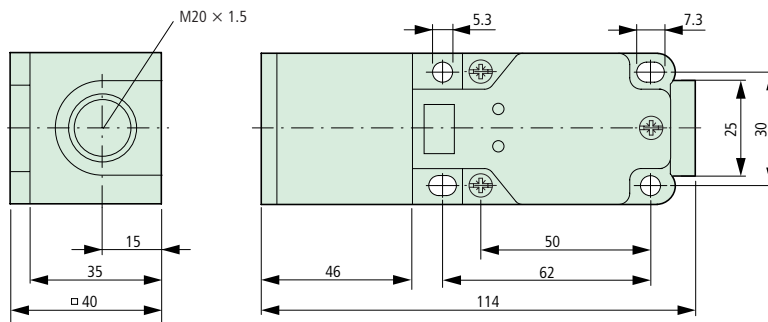

04/04 AWA1360-2156