



**Automatización Eléctrica**  
Especialistas en Automatización

At the end of this document you will find links to products related to this catalog. You can go directly to our shop by clicking [HERE](#). [HERE](#)

## Features

### Plug-in mount 10 A General purpose relay

- 2 & 3 pole changeover contacts
- Cadmium Free contacts (preferred version)
- AC coils & DC coils
- UL Listing (certain relay/socket combinations)
- Contact material options
- Lockable test button with mechanical flag indicator (preferred version)
- 90 series sockets
- Coil EMC suppression
- Timer accessories 86 series
- European Patent

60.12



- 2 pole, 10 A power contacts
- 8 pin plug-in

60.13



- 3 pole, 10 A power contacts
- 11 pin plug-in

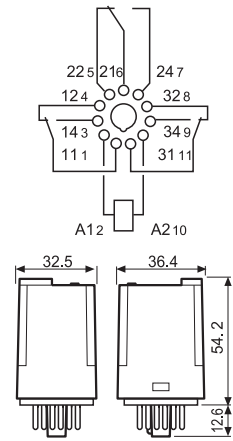
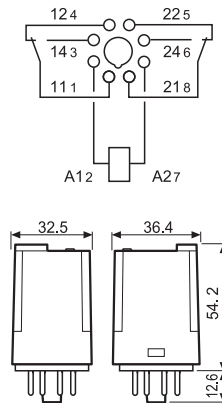

FOR UL RATINGS SEE:  
"General technical information" page V

Contact specification		60.12	60.13
Contact configuration		2 CO (DPDT)	3 CO (3PDT)
Rated current/Maximum peak current	A	10/20	10/20
Rated voltage/Maximum switching voltage	V AC	250/400	250/400
Rated load AC1	VA	2,500	2,500
Rated load AC15 (230 V AC)	VA	500	500
Single phase motor rating (230 V AC)	kW	0.37	0.37
Breaking capacity DC1: 30/110/220 V	A	10/0.4/0.15	10/0.4/0.15
Minimum switching load	mW (V/mA)	500 (10/5)	500 (10/5)
Standard contact material		AgNi	AgNi
Coil specification		60.12	60.13
Nominal voltage (U <sub>N</sub> )	V AC (50/60 Hz)	6 - 12 - 24 - 48 - 60 - 110 - 120 - 230 - 240 - 400	
	V DC	6 - 12 - 24 - 48 - 60 - 110 - 125 - 220	
Rated power AC/DC	VA (50 Hz)/W	2.2/1.3	2.2/1.3
Operating range	AC	(0.8...1.1)U <sub>N</sub>	(0.8...1.1)U <sub>N</sub>
	DC	(0.8...1.1)U <sub>N</sub>	(0.8...1.1)U <sub>N</sub>
Holding voltage	AC/DC	0.8 U <sub>N</sub> /0.5 U <sub>N</sub>	0.8 U <sub>N</sub> /0.5 U <sub>N</sub>
Must drop-out voltage	AC/DC	0.2 U <sub>N</sub> /0.1 U <sub>N</sub>	0.2 U <sub>N</sub> /0.1 U <sub>N</sub>
Technical data		60.12	60.13
Mechanical life AC/DC	cycles	20 · 10 <sup>6</sup> /50 · 10 <sup>6</sup>	20 · 10 <sup>6</sup> /50 · 10 <sup>6</sup>
Electrical life at rated load AC1	cycles	200 · 10 <sup>3</sup>	200 · 10 <sup>3</sup>
Operate/release time	ms	11/4	11/4
Insulation between coil and contacts (1.2/50 μs)	kV	4	3.6
Dielectric strength between open contacts	V AC	1,000	1,000
Ambient temperature range	°C	-40...+70	-40...+70
Environmental protection		RT I	RT I

### Approvals (according to type)



## Features

### Plug-in mount - 6 A

### Bifurcated contacts for low level switching

- 2 & 3 pole changeover contacts
- Cadmium Free contacts (Gold plated Silver Nickel)
- AC coils & DC coils
- Lockable test button with mechanical flag indicator (preferred version)
- 90 series sockets
- Coil EMC suppression
- Timer accessories 86 series
- European Patent

60.12 - 5200



- 2 pole, 6 A bifurcated contacts
- 8 pin plug-in

60.13 - 5200



- 3 pole, 6 A bifurcated contacts
- 11 pin plug-in

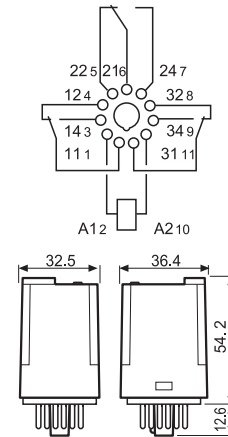
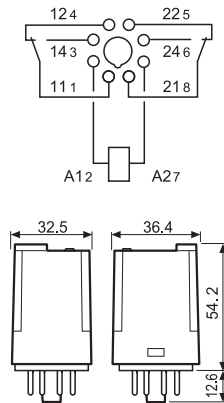

FOR UL RATINGS SEE:  
"General technical information" page V

Contact specification			
Contact configuration		2 CO (DPDT)	3 CO (3PDT)
Rated current/Maximum peak current	A	6/10	6/10
Rated voltage/Maximum switching voltage	V AC	250/400	250/400
Rated load AC1	VA	1,500	1,500
Rated load AC15 (230 V AC)	VA	250	250
Single phase motor rating (230 V AC)	kW	0.185	0.185
Breaking capacity DC1: 30/110/220 V	A	6/0.3/0.12	6/0.3/0.12
Minimum switching load	mW (V/mA)	50 (5/5)	50 (5/5)
Standard contact material		AgNi + Au (5 µm) bifurcated contacts	AgNi + Au (5 µm) bifurcated contacts
Coil specification			
Nominal voltage (U <sub>N</sub> )	V AC (50/60 Hz)	6 - 12 - 24 - 48 - 60 - 110 - 120 - 230 - 240 - 400	
	V DC	6 - 12 - 24 - 48 - 60 - 110 - 125 - 220	
Rated power AC/DC	VA (50 Hz)/W	2.2/1.3	2.2/1.3
Operating range	AC	(0.8...1.1)U <sub>N</sub>	(0.8...1.1)U <sub>N</sub>
	DC	(0.8...1.1)U <sub>N</sub>	(0.8...1.1)U <sub>N</sub>
Holding voltage	AC/DC	0.8 U <sub>N</sub> /0.5 U <sub>N</sub>	0.8 U <sub>N</sub> /0.5 U <sub>N</sub>
Must drop-out voltage	AC/DC	0.2 U <sub>N</sub> /0.1 U <sub>N</sub>	0.2 U <sub>N</sub> /0.1 U <sub>N</sub>
Technical data			
Mechanical life AC/DC	cycles	20 · 10 <sup>6</sup> /50 · 10 <sup>6</sup>	20 · 10 <sup>6</sup> /50 · 10 <sup>6</sup>
Electrical life at rated load AC1	cycles	250 · 10 <sup>3</sup>	250 · 10 <sup>3</sup>
Operate/release time	ms	11/4	11/4
Insulation between coil and contacts (1.2/50 µs)	kV	4	3.6
Dielectric strength between open contacts	V AC	1,000	1,000
Ambient temperature range	°C	-40...+70	-40...+70
Environmental protection		RT I	RT I

Approvals (according to type)



## Features

### Flange mount - General purpose relay 10 A

- Faston 187, 4.8x0.8 mm
- 2 & 3 pole changeover contacts
- AC coils & DC coils
- Cadmium Free contacts (preferred version)
- Contacts material options

60.62



- 2 pole, 10 A power contacts
- Flange mount/Faston 187

60.63



- 3 pole, 10 A power contacts
- Flange mount/Faston 187

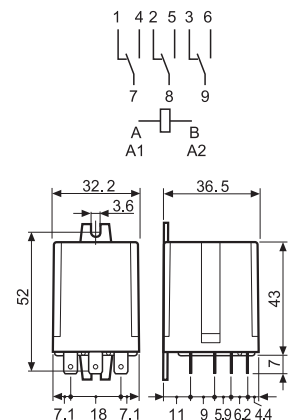
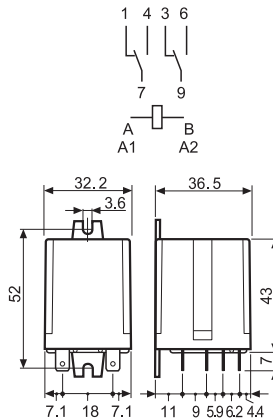

FOR UL RATINGS SEE:  
"General technical information" page V

### Contact specification

Contact configuration	2 CO (DPDT)	3 CO (3PDT)
Rated current/Maximum peak current	A 10/20	10/20
Rated voltage/Maximum switching voltage V AC	250/400	250/400
Rated load AC1	VA 2,500	2,500
Rated load AC15 (230 V AC)	VA 500	500
Single phase motor rating (230 V AC)	kW 0.37	0.37
Breaking capacity DC1: 30/110/220 V	A 10/0.4/0.15	10/0.4/0.15
Minimum switching load	mW (V/mA) 500 (10/5)	500 (10/5)
Standard contact material	AgNi	AgNi

### Coil specification

Nominal voltage (U <sub>N</sub> )	V AC (50/60 Hz)	6 - 12 - 24 - 48 - 60 - 110 - 120 - 230 - 240 - 400
	V DC	6 - 12 - 24 - 48 - 60 - 110 - 125 - 220
Rated power AC/DC	VA (50 Hz)/W	2.2/1.3
Operating range	AC	(0.8...1.1)U <sub>N</sub>
	DC	(0.8...1.1)U <sub>N</sub>
Holding voltage	AC/DC	0.8 U <sub>N</sub> /0.5 U <sub>N</sub>
Must drop-out voltage	AC/DC	0.2 U <sub>N</sub> /0.1 U <sub>N</sub>

### Technical data

Mechanical life AC/DC	cycles	20 · 10 <sup>6</sup> /50 · 10 <sup>6</sup>	20 · 10 <sup>6</sup> /50 · 10 <sup>6</sup>
Electrical life at rated load AC1	cycles	200 · 10 <sup>3</sup>	200 · 10 <sup>3</sup>
Operate/release time	ms	11/4	11/4
Insulation between coil and contacts (1.2/50 μs)	kV	4	3.6
Dielectric strength between open contacts	V AC	1,000	1,000
Ambient temperature range	°C	-40...+70	-40...+70
Environmental protection		RT I	RT I

### Approvals (according to type)



## Ordering information

Example: 60 series plug-in relay, 3 CO (3PDT), 12 V DC coil, test button and mechanical indicator.

<b>6</b>	<b>0</b>	.	<b>1</b>	.	<b>3</b>	.	<b>9</b>	.	<b>0</b>	<b>1</b>	<b>2</b>	.	<b>0</b>	<b>A</b>	<b>0</b>	<b>B</b>	<b>0</b>	<b>C</b>	<b>4</b>	<b>D</b>	<b>0</b>
----------	----------	---	----------	---	----------	---	----------	---	----------	----------	----------	---	----------	----------	----------	----------	----------	----------	----------	----------	----------

**Series** —————

**Type** —————

1 = 8/11 pin plug-in  
6 = Faston 187 (4.8x0.8 mm) with flange mount

**No. of poles** —————

2 = 2 pole  
3 = 3 pole

**Coil version** —————

4 = Current sensing (60.12/13 only)  
8 = AC (50/60 Hz)  
9 = DC

**Coil voltage** —————

See coil specifications

**A: Contact material**  
0 = Standard  
2 = AgCdO  
5 = AgNi + Au (5 µm)

**B: Contact circuit**  
0 = CO (nPDT)  
2 = Bifurcated contacts  
60.12/13 - 6 A only

**D: Special versions**  
0 = Standard

**C: Options**  
0 = None  
2 = Mechanical indicator  
3 = LED (AC)  
4 = Lockable test button + mechanical indicator  
5\* = Lockable test button + LED (AC)  
54\* = Lockable test button + LED (AC) + mechanical indicator  
6\* = LED + diode (DC, polarity positive to pin 2)  
7\* = Lockable test button + LED + diode (DC, polarity positive to pin 2)  
74\* = Lockable test button + LED + diode (DC, polarity positive to pin 2) + mechanical indicator

\* Options not available for 220 V DC and 400 V AC versions.

**Selecting features and options: only combinations in the same row are possible.**  
Preferred selections for best availability are shown in **bold**.

Type	Coil version	A	B	C	D
60.12/13	AC	<b>0 - 2</b>	<b>0</b>	0 - 2 - 3 - <b>4</b> - 5	<b>0</b>
	AC	0 - 2	0	54	/
	AC	5	0 - 2	0 - 2 - 3 - 4 - 5	0
	AC	5	0 - 2	54	/
	DC	<b>0 - 2</b>	<b>0</b>	0 - 2 - <b>4</b> - 6 - 7	<b>0</b>
	DC	0 - 2	0	74	/
	DC	5	0 - 2	0 - 2 - 4 - 6 - 7	0
	DC	5	0 - 2	74	/
	current sensing	0	0	4	0
60.62/63	AC-DC	<b>0 - 2 - 5</b>	<b>0</b>	<b>0</b>	<b>0</b>

### Descriptions: Options and Special versions

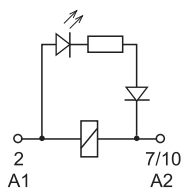

**C: Option 3, 5, 54**  
LED (AC)

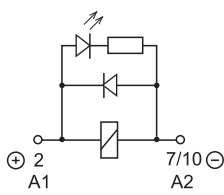

**C: Option 6, 7, 74**  
LED + diode (DC, polarity positive to pin 2)



### Lockable test button and mechanical indicator (0040, 0050, 0054, 0070, 0074)

The dual-purpose Finder test button can be used in two ways:

**Case 1)** The plastic pip (located directly above the test button) remains intact. In this case, when the test button is pushed, the contacts operate. When the test button is released the contacts return to their former state.

**Case 2)** The plastic pip is broken-off (using an appropriate cutting tool). In this case, (in addition to the above function), when the test button is pushed and rotated, the contacts are latched in the operating state, and remain so until the test button is rotated back to its former position. In both cases ensure that the test button actuation is swift and decisive.



## Technical data

Insulation according to EN 61810-1		2 pole		3 pole	
Nominal voltage of supply system	V AC	230/400		230/400	
Rated insulation voltage	V AC	250	400	250	400
Pollution degree		3	2	3	2
<b>Insulation between coil and contact set</b>					
Type of insulation		Basic		Basic	
Overvoltage category		III		III	
Rated impulse voltage	kV (1.2/50 $\mu$ s)	4		3.6	
Dielectric strength	V AC	2,000		2,000	
<b>Insulation between adjacent contacts</b>					
Type of insulation		Basic		Basic	
Overvoltage category		III		III	
Rated impulse voltage	kV (1.2/50 $\mu$ s)	4		3.6	
Dielectric strength	V AC	2,000		2,000	
<b>Insulation between open contacts</b>					
Type of disconnection		Micro-disconnection		Micro-disconnection	
Dielectric strength	V AC/kV (1.2/50 $\mu$ s)	1,000/1.5		1,000/1.5	
<b>Conducted disturbance immunity</b>					
Burst (5...50)ns, 5 kHz, on A1 - A2		EN 61000-4-4		level 4 (4 kV)	
Surge (1.2/50 $\mu$ s) on A1 - A2 (differential mode)		EN 61000-4-5		level 4 (4 kV)	
<b>Other data</b>					
Bounce time: NO/NC	ms	1/4			
Vibration resistance (5...55)Hz: NO/NC	g	22/22			
Shock resistance	g	20			
Power lost to the environment	without contact current	W	1.3	1.3	
	with rated current	W	2.7 (60.12, 60.62)	3.4 (60.13, 60.63)	

## Contact specification

F 60 - Electrical life (AC) v contact current

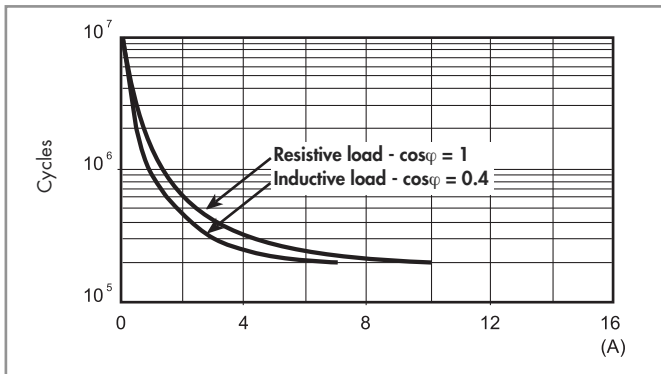

H 60 - Maximum DC1 breaking capacity

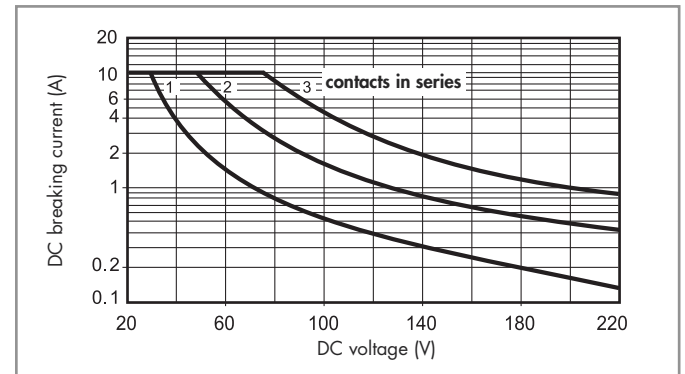

- When switching a resistive load (DC1) having voltage and current values under the curve, an electrical life of  $\geq 100 \cdot 10^3$  can be expected.
- In the case of DC13 loads, the connection of a diode in parallel with the load will permit a similar electrical life as for a DC1 load.  
Note: the release time for the load will be increased.

## Coil specifications

DC coil data

Nominal voltage $U_N$ V	Coil code	Operating range		Resistance R $\Omega$	Rated coil consumption I at $U_N$ mA
		$U_{min}$ V	$U_{max}$ V		
6	9.006	4.8	6.6	28	214
12	9.012	9.6	13.2	110	109
24	9.024	19.2	26.4	445	53.9
48	9.048	38.4	52.8	1,770	27.1
60	9.060	48	66	2,760	21.7
110	9.110	88	121	9,420	11.7
125	9.125	100	138	12,000	10.4
220	9.220	176	242	37,300	5.8

AC coil data

Nominal voltage $U_N$ V	Coil code	Operating range		Resistance R $\Omega$	Rated coil consumption I at $U_N$ (50Hz) mA
		$U_{min}$ V	$U_{max}$ V		
6	8.006	4.8	6.6	4.6	367
12	8.012	9.6	13.2	19	183
24	8.024	19.2	26.4	74	90
48	8.048	38.4	52.8	290	47
60	8.060	48	66	450	37
110	8.110	88	121	1,600	20
120	8.120	96	132	1,940	18.6
230	8.230	184	253	7,250	10.5
240	8.240	192	264	8,500	9.2
400	8.400	320	440	19,800	6

## Coil specifications

R 60 - DC coil operating range v ambient temperature

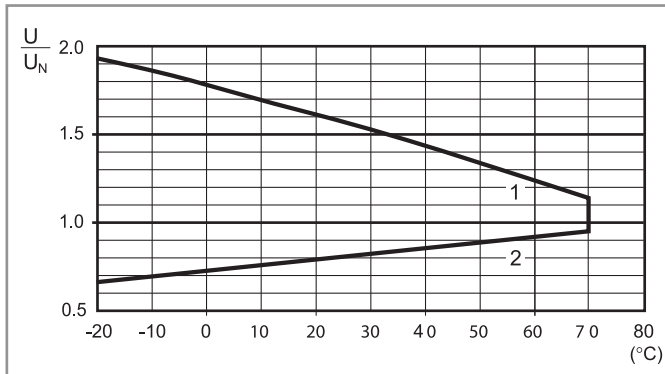

- 1 - Max. permitted coil voltage.
- 2 - Min. pick-up voltage with coil at ambient temperature.

R 60 - AC coil operating range v ambient temperature

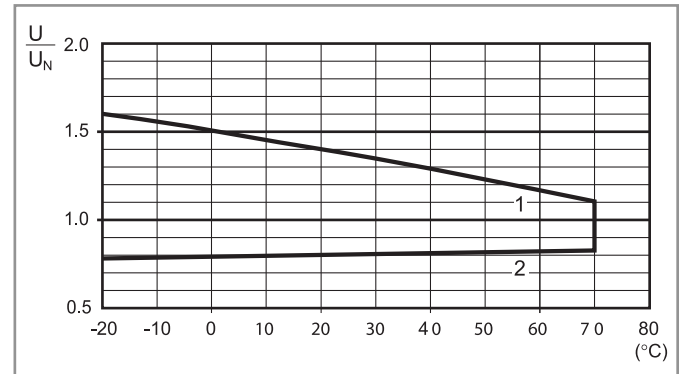

- 1 - Max. permitted coil voltage.
- 2 - Min. pick-up voltage with coil at ambient temperature.

## Current sensing version

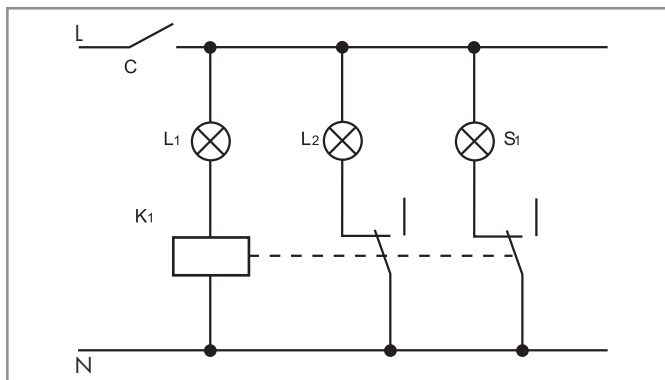

Typical application with current sensing relays.  
An open circuit filament of lamp L1 is detected by the current sensing relay coil (K1) which causes the back-up safety lamp L2 to be energised, and indication of failure at the control panel via lamp S1.

Example: navigation light.

- L1 = Light
- L2 = Safety light
- S1 = Control light
- K1 = Relay

Current sensing DC coil data

Coil code	$I_{min}$ (A)	$I_N$ (A)	$I_{max}$ (A)	R ( $\Omega$ )
4202	1.7	2.0	2.4	0.15
4182	1.5	1.8	2.2	0.19
4162	1.4	1.6	1.9	0.24
4142	1.2	1.4	1.7	0.31
4122	1.0	1.2	1.4	0.42
4102	0.85	1.0	1.2	0.61
4092	0.8	0.9	1.1	0.75
4062	0.5	0.6	0.7	1.70
4032	0.25	0.3	0.4	6.70
4012	0.085	0.1	0.15	61

Current sensing AC coil data

Coil code	$I_{min}$ (A)	$I_N$ (A)	$I_{max}$ (A)	R ( $\Omega$ )
4251	2.1	2.5	3.0	0.05
4181	1.5	1.8	2.2	0.10
4161	1.4	1.6	1.9	0.12
4121	1.0	1.2	1.4	0.22
4101	0.85	1.0	1.2	0.32
4051	0.42	0.5	0.6	1.28
4041	0.34	0.4	0.5	2.00
4031	0.25	0.3	0.4	3.57
4021	0.17	0.2	0.25	8.0
4011	0.085	0.1	0.15	32.1

Other types of current sensing relays are available on request.

## Accessories

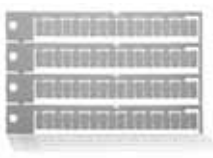

060.72

Sheet of marker tags for relay types 60.12 and 60.13, plastic, 72 tags, 6x12 mm

060.72



Module	Socket	Relay	Description	Mounting	Accessories
99.02	90.02	60.12	Screw terminal (Box clamp) socket Double A1 terminal	Panel or 35 mm rail (EN 60715) mount	<ul style="list-style-type: none"> <li>- Coil indication and EMC suppression modules</li> <li>- Jumper link</li> <li>- Timer modules</li> <li>- Metal retaining clip</li> </ul>
	90.03	60.13			



Module	Socket	Relay	Description	Mounting	Accessories
99.01	90.20	60.12	Screw terminal (Box clamp) socket	Panel or 35 mm rail (EN 60715) mount	<ul style="list-style-type: none"> <li>- Coil indication and EMC suppression modules</li> <li>- Metal retaining clip</li> </ul>
	90.21	60.13			

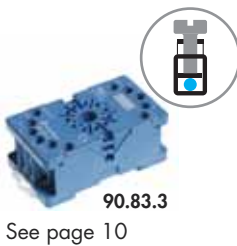

Module	Socket	Relay	Description	Mounting	Accessories
—	90.82.3	60.12	Screw terminal (Box clamp) socket	Panel or 35 mm rail (EN 60715) mount	- Metal retaining clip
—	90.83.3	60.13			



Module	Socket	Relay	Description	Mounting	Accessories
—	90.22	60.12	Screw terminal (Box clamp) socket	Panel or 35 mm rail (EN 60715) mount	- Metal retaining clip
—	90.23	60.13			

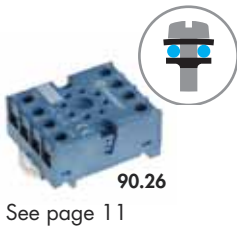

Module	Socket	Relay	Description	Mounting	Accessories
—	90.26	60.12	Screw terminal (Plate clamp) socket	Panel or 35 mm rail (EN 60715) mount	- Metal retaining clip
—	90.27	60.13			



Module	Socket	Relay	Description	Mounting	Accessories
—	90.12	60.12	Flange mount solder socket	M3 screw fixing	—
—	90.13	60.13			



Module	Socket	Relay	Description	Mounting	Accessories
—	90.14	60.12	PCB socket	PCB	—
—	90.14.1	60.12			
—	90.15	60.13			
—	90.15.1	60.13			





90.03

Approvals (according to type):



Certain relay/socket combinations

Screw terminal (Box clamp) socket panel or 35 mm rail (EN 60715) mount For relay type	90.02 Blue	90.02.0 Black	90.03 Blue	90.03.0 Black
<b>Accessories</b>				
Metal retaining clip			090.33	
6-way jumper link			090.06	
Identification tag			090.00.2	
Modules (see table below)			99.02	
Timer modules (see table below)			86.00, 86.30	
<b>Technical data</b>				
Rated values	10 A - 250 V			
Dielectric strength	2 kV AC			
Protection category	IP 20			
Ambient temperature	°C -40...+70			
Screw torque	Nm 0.6			
Wire strip length	mm 10			
Max. wire size for 90.02 and 90.03 sockets	solid wire		stranded wire	
	mm <sup>2</sup> 1x6 / 2x2.5		1x4 / 2x2.5	
	AWG 1x10 / 2x14		1x12 / 2x14	

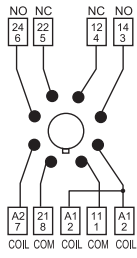

90.02

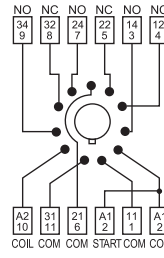
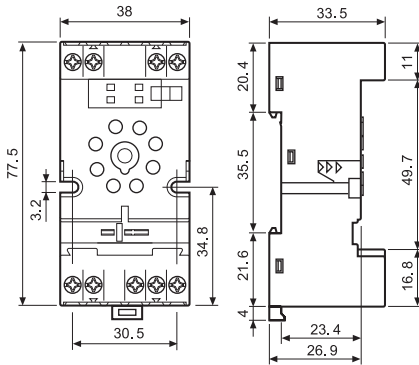

90.03

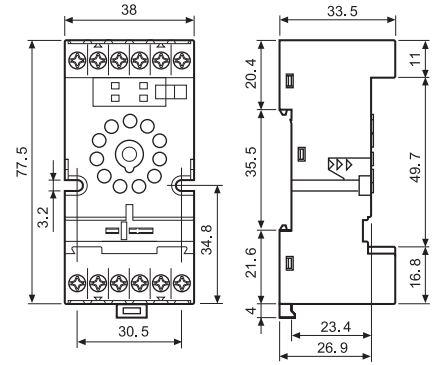

6-way jumper link for 90.02 and 90.03 sockets	090.06 (blue)	090.06.0 (black)
Rated values	10 A - 250 V	

090.06

Approvals (according to type):

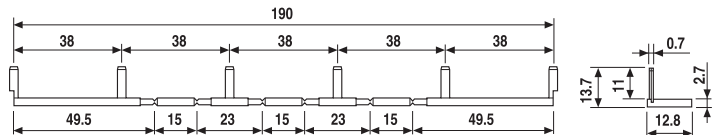

86.00



86.30



86 series timer modules		
Multi-voltage: (12...240)V AC/DC;		
Multi-functions: AI, DI, SW, BE, CE, DE, EE, FE; (0.05 s...100 h)		86.00.0.240.0000
(12...24)V AC/DC; Bi-function: AI, DI; (0.05 s...100 h)		86.30.0.024.0000
(110...125)V AC; Bi-function: AI, DI; (0.05s...100h)		86.30.8.120.0000
(230...240)V AC; Bi-function: AI, DI; (0.05 s...100 h)		86.30.8.240.0000

Approvals (according to type):

99.02



Approvals (according to type):



99.02 coil indication and EMC suppression modules for 90.02 and 90.03 sockets		
Diode (+A1, standard polarity)	(6...220)V DC	99.02.3.000.00
LED	(6...24)V DC/AC	99.02.0.024.59
LED	(28...60)V DC/AC	99.02.0.060.59
LED	(110...240)V DC/AC	99.02.0.230.59
LED + Diode (+A1, standard polarity)	(6...24)V DC	99.02.9.024.99
LED + Diode (+A1, standard polarity)	(28...60)V DC	99.02.9.060.99
LED + Diode (+A1, standard polarity)	(110...220)V DC	99.02.9.220.99
LED + Varistor	(6...24)V DC/AC	99.02.0.024.98
LED + Varistor	(28...60)V DC/AC	99.02.0.060.98
LED + Varistor	(110...240)V DC/AC	99.02.0.230.98
RC circuit	(6...24)V DC/AC	99.02.0.024.09
RC circuit	(28...60)V DC/AC	99.02.0.060.09
RC circuit	(110...240)V DC/AC	99.02.0.230.09
Residual current by-pass	(110...240)V AC	99.02.8.230.07

DC Modules with non-standard polarity (+A2) on request.



**90.21**

Approvals (according to type):



Screw terminal (Box clamp) socket	90.20	90.20.0	90.21	90.21.0
	Blue	Black	Blue	Black
panel or 35 mm rail (EN 60715) mount				
For relay type	60.12		60.13	
<b>Accessories</b>				
Metal retaining clip (supplied with socket - packaging code SMA)			090.33	
Modules (see table below)			99.01	
<b>Technical data</b>				
Rated values	10 A - 250 V			
Dielectric strength	2 kV AC			
Protection category	IP 20			
Ambient temperature	°C -40...+70			
⊕ Screw torque	Nm	0.5		
Wire strip length	mm	10		
Max. wire size for 90.20 and 90.21 sockets		solid wire	stranded wire	
	mm <sup>2</sup>	1x6 / 2x2.5		1x6 / 2x2.5
	AWG	1x10 / 2x14		1x10 / 2x14

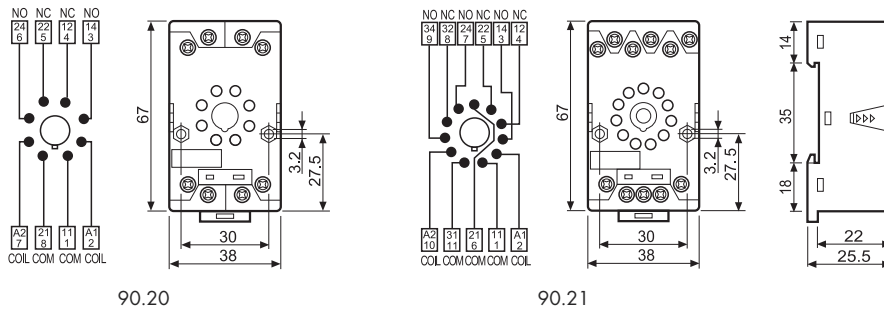

**99.01**

Approvals (according to type):



\* Modules in Black housing are available on request.

Green LED is standard. Red LED available on request.

99.01 coil indication and EMC suppression modules for 90.20 and 90.21 sockets		Blue*
See technical data page 215/216		
Diode (+A1, standard polarity)	(6...220)V DC	99.01.3.000.00
Diode (+A2, non-standard polarity)	(6...220)V DC	99.01.2.000.00
LED	(6...24)V DC/AC	99.01.0.024.59
LED	(28...60)V DC/AC	99.01.0.060.59
LED	(110...240)V DC/AC	99.01.0.230.59
LED + Diode (+A1, standard polarity)	(6...24)V DC	99.01.9.024.99
LED + Diode (+A1, standard polarity)	(28...60)V DC	99.01.9.060.99
LED + Diode (+A1, standard polarity)	(110...220)V DC	99.01.9.220.99
LED + Diode (+A2, non-standard polarity)	(6...24)V DC	99.01.9.024.79
LED + Diode (+A2, non-standard polarity)	(28...60)V DC	99.01.9.060.79
LED + Diode (+A2, non-standard polarity)	(110...220)V DC	99.01.9.220.79
LED + Varistor	(6...24)V DC/AC	99.01.0.024.98
LED + Varistor	(28...60)V DC/AC	99.01.0.060.98
LED + Varistor	(110...240)V DC/AC	99.01.0.230.98
RC circuit	(6...24)V DC/AC	99.01.0.024.09
RC circuit	(28...60)V DC/AC	99.01.0.060.09
RC circuit	(110...240)V DC/AC	99.01.0.230.09
Residual current by-pass	(110...240)V AC	99.01.8.230.07



90.83.3

Approvals  
(according to type):



Screw terminal (Box clamp) socket panel or 35 mm rail (EN 60715) mount	90.82.3 Blue	90.82.30 Black	90.83.3 Blue	90.83.30 Black
For relay type	60.12		60.13	
<b>Accessories</b>				
Metal retaining clip	090.33			
<b>Technical data</b>				
Rated values	10 A - 250 V			
Dielectric strength	2 kV AC			
Protection category	IP 20			
Ambient temperature	°C -40...+70			
⊕ Screw torque	Nm 0.8			
Max. wire size for 90.82.3 and 90.83.3 sockets	solid wire		stranded wire	
	mm <sup>2</sup> 1x6 / 2x4		1x6 / 2x4	
	AWG 1x10 / 2x14		1x10 / 2x14	

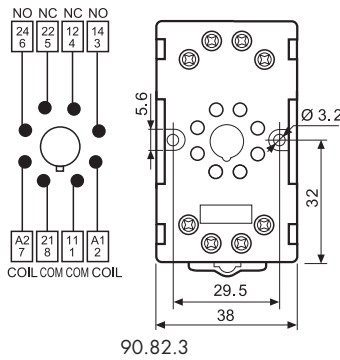

90.82.3

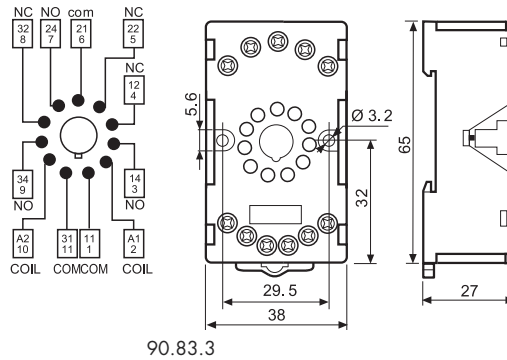

90.83.3



90.23

Approvals  
(according to type):



Screw (Box clamp) terminal socket panel or 35 mm rail (EN 60715) mount	90.22 Blue	90.23 Blue
For relay type	60.12	
<b>Accessories</b>		
Metal retaining clip (supplied with socket - packaging code SMA)	090.33	
<b>Technical data</b>		
Rated values	10 A - 250 V	
Dielectric strength	2 kV AC	
Protection category	IP 20	
Ambient temperature	°C -40...+70	
⊕ Screw torque	Nm 0.5	
Wire strip length	mm 7	
Max wire size for 90.22 and 90.23 sockets	solid wire	
	mm <sup>2</sup> 1x6 / 2x2.5	
	AWG 1x10 / 2x14	

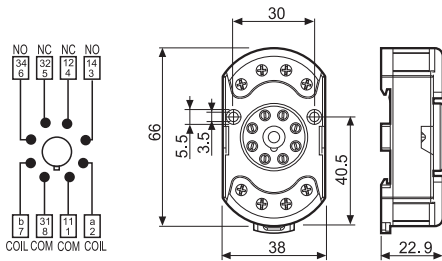

90.22

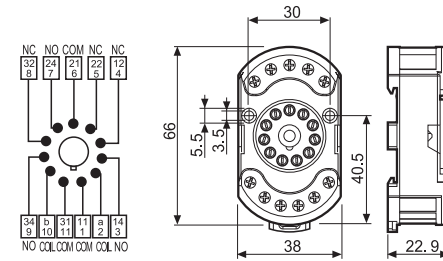

90.23

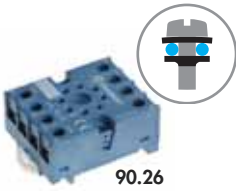

90.26

Approvals  
(according to type):



Screw terminal (Plate clamp) socket	90.26	90.26.0	90.27	90.27.0
panel or 35 mm rail (EN 60715) mount	Blue	Black	Blue	Black
For relay type	60.12		60.13	
<b>Accessories</b>				
Metal retaining clip (supplied with socket - packaging code SMA)				090.33
<b>Technical data</b>				
Rated values	10 A - 250 V			
Dielectric strength	2 kV AC			
Protection category	IP 20			
Ambient temperature	°C -40...+70			
⊕ Screw torque	Nm	0.8		
Wire strip length	mm	10		
Max. wire size for 90.26 and 90.27 sockets		solid wire	stranded wire	
	mm <sup>2</sup>	1x4 / 2x2.5		1x4 / 2x2.5
	AWG	1x12 / 2x14		1x12 / 2x14



90.26

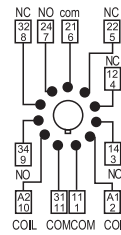
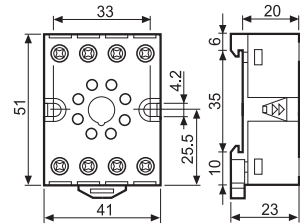

90.27

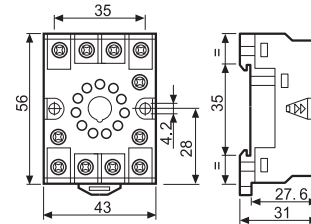

90.12

Approvals  
(according to type):



Flange mount solder socket mount with M3 screw	90.12 (black)	90.13 (black)
For relay type	60.12	60.13
<b>Technical data</b>		
Rated values	10 A - 250 V	
Dielectric strength	2 kV AC	
Ambient temperature	°C -40...+70	

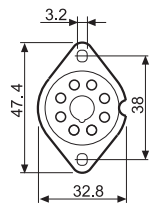

90.12

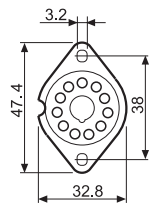

90.13

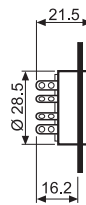



90.15

Approvals  
(according to type):



<b>PCB socket</b>	<b>Blue</b>	<b>90.14 (Ø 20.5 mm)</b>	<b>90.15 (Ø 22 mm)</b>
	<b>Blue</b>	<b>90.14.1 (Ø 17.5 mm)</b>	<b>90.15.1 (Ø 19 mm)</b>
For relay type		60.12	60.13
<b>Technical data</b>			
Rated values		10 A - 250 V	
Dielectric strength		2 kV AC	
Ambient temperature	°C	-40...+70	

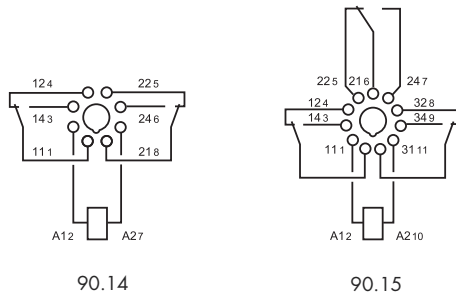
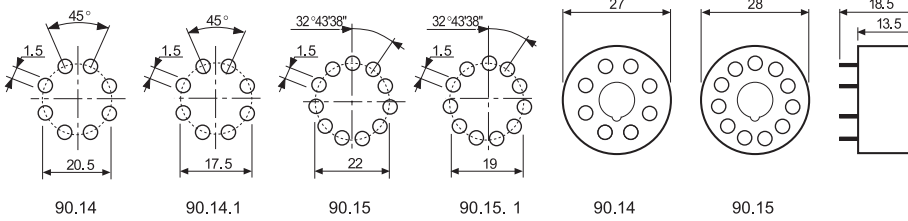

## Packaging code

How to code and identify retaining clip and packaging options for sockets.

Example:

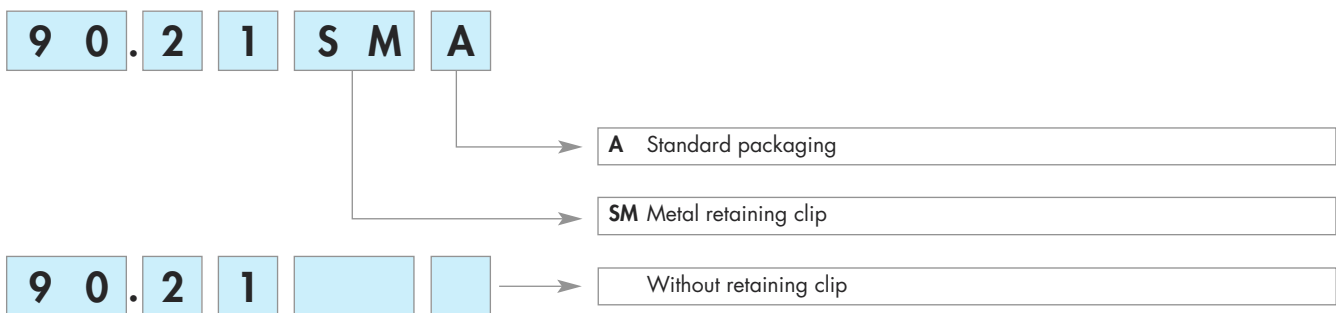

Below is a list of articles with direct links to our shop Electric Automation Network where you can see:

- Quote per purchase volume in real time.
- Online documentation and datasheets of all products.
- Estimated delivery time enquiry in real time.
- Logistics systems for the shipment of materials almost anywhere in the world.
- Purchasing management, order record and tracking of shipments.

To access the product, [click on the green button.](#)

Product	Code	Reference	Product link
Sheet of 72 plottable snap-in identification tags	06072	060.72	<a href="#">Buy on EAN</a>
Current sensing coil; (add to 1st column price)	601240110040	60.12.4.011.0040	<a href="#">Buy on EAN</a>
Current sensing coil; (add to 1st column price)	601240110040PAS	60.12.4.011.0040PAS	<a href="#">Buy on EAN</a>
Current sensing coil; (add to 1st column price)	601240120040	60.12.4.012.0040	<a href="#">Buy on EAN</a>
Current sensing coil; (add to 1st column price)	601240120040PAS	60.12.4.012.0040PAS	<a href="#">Buy on EAN</a>
Current sensing coil; (add to 1st column price)	601240210040	60.12.4.021.0040	<a href="#">Buy on EAN</a>
Current sensing coil; (add to 1st column price)	601240210040PAS	60.12.4.021.0040PAS	<a href="#">Buy on EAN</a>
Current sensing coil; (add to 1st column price)	601240220040	60.12.4.022.0040	<a href="#">Buy on EAN</a>
Current sensing coil; (add to 1st column price)	601240220040PAS	60.12.4.022.0040PAS	<a href="#">Buy on EAN</a>
Current sensing coil; (add to 1st column price)	601240310040	60.12.4.031.0040	<a href="#">Buy on EAN</a>
Current sensing coil; (add to 1st column price)	601240310040PAS	60.12.4.031.0040PAS	<a href="#">Buy on EAN</a>
Current sensing coil; (add to 1st column price)	601240320040	60.12.4.032.0040	<a href="#">Buy on EAN</a>
Current sensing coil; (add to 1st column price)	601240320040PAS	60.12.4.032.0040PAS	<a href="#">Buy on EAN</a>
Current sensing coil; (add to 1st column price)	601240410040	60.12.4.041.0040	<a href="#">Buy on EAN</a>

Current sensing coil; (add to 1st column price)	601240410040PAS	60.12.4.041.0040PAS	Buy on EAN
Current sensing coil; (add to 1st column price)	601240420040	60.12.4.042.0040	Buy on EAN
Current sensing coil; (add to 1st column price)	601240420040PAS	60.12.4.042.0040PAS	Buy on EAN
Current sensing coil; (add to 1st column price)	601240510040	60.12.4.051.0040	Buy on EAN
Current sensing coil; (add to 1st column price)	601240510040PAS	60.12.4.051.0040PAS	Buy on EAN
Current sensing coil; (add to 1st column price)	601240520040	60.12.4.052.0040	Buy on EAN
Current sensing coil; (add to 1st column price)	601240520040PAS	60.12.4.052.0040PAS	Buy on EAN
Current sensing coil; (add to 1st column price)	601240610040	60.12.4.061.0040	Buy on EAN
Current sensing coil; (add to 1st column price)	601240610040PAS	60.12.4.061.0040PAS	Buy on EAN
Current sensing coil; (add to 1st column price)	601240620040	60.12.4.062.0040	Buy on EAN
Current sensing coil; (add to 1st column price)	601240620040PAS	60.12.4.062.0040PAS	Buy on EAN
Current sensing coil; (add to 1st column price)	601240710040	60.12.4.071.0040	Buy on EAN
Current sensing coil; (add to 1st column price)	601240710040PAS	60.12.4.071.0040PAS	Buy on EAN
Current sensing coil; (add to 1st column price)	601240720040	60.12.4.072.0040	Buy on EAN
Current sensing coil; (add to 1st column price)	601240720040PAS	60.12.4.072.0040PAS	Buy on EAN
Current sensing coil; (add to 1st column price)	601240810040	60.12.4.081.0040	Buy on EAN
Current sensing coil; (add to 1st column price)	601240810040PAS	60.12.4.081.0040PAS	Buy on EAN
Current sensing coil; (add to 1st column price)	601240820040	60.12.4.082.0040	Buy on EAN
Current sensing coil; (add to 1st column price)	601240820040PAS	60.12.4.082.0040PAS	Buy on EAN
Current sensing coil; (add to 1st column price)	601240910040	60.12.4.091.0040	Buy on EAN
Current sensing coil; (add to 1st column price)	601240910040PAS	60.12.4.091.0040PAS	Buy on EAN
Current sensing coil; (add to 1st column price)	601240920040	60.12.4.092.0040	Buy on EAN
Current sensing coil; (add to 1st column price)	601240920040PAS	60.12.4.092.0040PAS	Buy on EAN

Current sensing coil; (add to 1st column price)	601241010040	60.12.4.101.0040	Buy on EAN
Current sensing coil; (add to 1st column price)	601241010040PAS	60.12.4.101.0040PAS	Buy on EAN
Current sensing coil; (add to 1st column price)	601241020040	60.12.4.102.0040	Buy on EAN
Current sensing coil; (add to 1st column price)	601241020040PAS	60.12.4.102.0040PAS	Buy on EAN
Current sensing coil; (add to 1st column price)	601241210040	60.12.4.121.0040	Buy on EAN
Current sensing coil; (add to 1st column price)	601241210040PAS	60.12.4.121.0040PAS	Buy on EAN
Current sensing coil; (add to 1st column price)	601241220040	60.12.4.122.0040	Buy on EAN
Current sensing coil; (add to 1st column price)	601241220040PAS	60.12.4.122.0040PAS	Buy on EAN
Current sensing coil; (add to 1st column price)	601241410040	60.12.4.141.0040	Buy on EAN
Current sensing coil; (add to 1st column price)	601241410040PAS	60.12.4.141.0040PAS	Buy on EAN
Current sensing coil; (add to 1st column price)	601241420040	60.12.4.142.0040	Buy on EAN
Current sensing coil; (add to 1st column price)	601241420040PAS	60.12.4.142.0040PAS	Buy on EAN
Current sensing coil; (add to 1st column price)	601241610040	60.12.4.161.0040	Buy on EAN
Current sensing coil; (add to 1st column price)	601241610040PAS	60.12.4.161.0040PAS	Buy on EAN
Current sensing coil; (add to 1st column price)	601241620040	60.12.4.162.0040	Buy on EAN
Current sensing coil; (add to 1st column price)	601241620040PAS	60.12.4.162.0040PAS	Buy on EAN
Current sensing coil; (add to 1st column price)	601241810040	60.12.4.181.0040	Buy on EAN
Current sensing coil; (add to 1st column price)	601241810040PAS	60.12.4.181.0040PAS	Buy on EAN
Current sensing coil; (add to 1st column price)	601241820040	60.12.4.182.0040	Buy on EAN
Current sensing coil; (add to 1st column price)	601241820040PAS	60.12.4.182.0040PAS	Buy on EAN
Current sensing coil; (add to 1st column price)	601242010040	60.12.4.201.0040	Buy on EAN
Current sensing coil; (add to 1st column price)	601242010040PAS	60.12.4.201.0040PAS	Buy on EAN
Current sensing coil; (add to 1st column price)	601242020040	60.12.4.202.0040	Buy on EAN



Current sensing coil; (add to 1st column price)	601242020040PAS	60.12.4.202.0040PAS	Buy on EAN
Current sensing coil; (add to 1st column price)	601242220040	60.12.4.222.0040	Buy on EAN
Current sensing coil; (add to 1st column price)	601242220040PAS	60.12.4.222.0040PAS	Buy on EAN
Current sensing coil; (add to 1st column price)	601242310040	60.12.4.231.0040	Buy on EAN
Current sensing coil; (add to 1st column price)	601242310040PAS	60.12.4.231.0040PAS	Buy on EAN
Current sensing coil; (add to 1st column price)	601242510040	60.12.4.251.0040	Buy on EAN
Current sensing coil; (add to 1st column price)	601242510040PAS	60.12.4.251.0040PAS	Buy on EAN
Current sensing coil; (add to 1st column price)	601242520040	60.12.4.252.0040	Buy on EAN
Current sensing coil; (add to 1st column price)	601242520040PAS	60.12.4.252.0040PAS	Buy on EAN
Current sensing coil; (add to 1st column price)	601242810040	60.12.4.281.0040	Buy on EAN
Current sensing coil; (add to 1st column price)	601242810040PAS	60.12.4.281.0040PAS	Buy on EAN
Current sensing coil; (add to 1st column price)	601242820040	60.12.4.282.0040	Buy on EAN
Current sensing coil; (add to 1st column price)	601242820040PAS	60.12.4.282.0040PAS	Buy on EAN
Current sensing coil; (add to 1st column price)	601243210040	60.12.4.321.0040	Buy on EAN
Current sensing coil; (add to 1st column price)	601243210040PAS	60.12.4.321.0040PAS	Buy on EAN
Current sensing coil; (add to 1st column price)	601243220040	60.12.4.322.0040	Buy on EAN
Current sensing coil; (add to 1st column price)	601243220040PAS	60.12.4.322.0040PAS	Buy on EAN
Current sensing coil; (add to 1st column price)	601243610040	60.12.4.361.0040	Buy on EAN
Current sensing coil; (add to 1st column price)	601243610040PAS	60.12.4.361.0040PAS	Buy on EAN
Current sensing coil; (add to 1st column price)	601243620040	60.12.4.362.0040	Buy on EAN
Current sensing coil; (add to 1st column price)	601243620040PAS	60.12.4.362.0040PAS	Buy on EAN
Current sensing coil; (add to 1st column price)	601244010040	60.12.4.401.0040	Buy on EAN
Current sensing coil; (add to 1st column price)	601244010040PAS	60.12.4.401.0040PAS	Buy on EAN

Current sensing coil; (add to 1st column price)	601244020040	60.12.4.402.0040	<a href="#">Buy on EAN</a>
Current sensing coil; (add to 1st column price)	601244020040PAS	60.12.4.402.0040PAS	<a href="#">Buy on EAN</a>
Current sensing coil; (add to 1st column price)	601244510040	60.12.4.451.0040	<a href="#">Buy on EAN</a>
Current sensing coil; (add to 1st column price)	601244510040PAS	60.12.4.451.0040PAS	<a href="#">Buy on EAN</a>
Current sensing coil; (add to 1st column price)	601244520040	60.12.4.452.0040	<a href="#">Buy on EAN</a>
Current sensing coil; (add to 1st column price)	601244520040PAS	60.12.4.452.0040PAS	<a href="#">Buy on EAN</a>
Current sensing coil; (add to 1st column price)	601245010040	60.12.4.501.0040	<a href="#">Buy on EAN</a>
Current sensing coil; (add to 1st column price)	601245010040PAS	60.12.4.501.0040PAS	<a href="#">Buy on EAN</a>
Current sensing coil; (add to 1st column price)	601245020040	60.12.4.502.0040	<a href="#">Buy on EAN</a>
Current sensing coil; (add to 1st column price)	601245020040PAS	60.12.4.502.0040PAS	<a href="#">Buy on EAN</a>
General purpose relay	601280060000	60.12.8.006.0000	<a href="#">Buy on EAN</a>
8-pin;Plug-in;AgNi;2CO 10A;lockable test btton+flag indicator	601280060040	60.12.8.006.0040	<a href="#">Buy on EAN</a>
8-pin;Plug-in;AgNi;2CO 10A;lockable test btton+flag indicator	601280060040PAS	60.12.8.006.0040PAS	<a href="#">Buy on EAN</a>
General purpose relay	601280120000	60.12.8.012.0000	<a href="#">Buy on EAN</a>
Flag indicator (60.12/60.13 only)	601280120020	60.12.8.012.0020	<a href="#">Buy on EAN</a>
LED (60.12/60.13 coil voltages up to 240V AC only)	601280120030	60.12.8.012.0030	<a href="#">Buy on EAN</a>
8-pin;Plug-in;AgNi;2CO 10A;lockable test btton+flag indicator	601280120040	60.12.8.012.0040	<a href="#">Buy on EAN</a>
8-pin;Plug-in;AgNi;2CO 10A;lockable test btton+flag indicator	601280120040PAS	60.12.8.012.0040PAS	<a href="#">Buy on EAN</a>
Lockable test button + LED (60.12/60.13 coil voltages up to 240V AC only)	601280120050	60.12.8.012.0050	<a href="#">Buy on EAN</a>
AgCdO contacts (60.12/60.13 only)	601280122000	60.12.8.012.2000	<a href="#">Buy on EAN</a>
AgCdO contacts (60.12/60.13 only)	601280122040	60.12.8.012.2040	<a href="#">Buy on EAN</a>
AgCdO contacts (60.12/60.13 only)	601280122050	60.12.8.012.2050	<a href="#">Buy on EAN</a>
AgNi+Au contacts (60.12/60.13 only)	601280125000	60.12.8.012.5000	<a href="#">Buy on EAN</a>

General purpose relay	601280240000	60.12.8.024.0000	<a href="#">Buy on EAN</a>
Flag indicator (60.12/60.13 only)	601280240020	60.12.8.024.0020	<a href="#">Buy on EAN</a>
LED (60.12/60.13 coil voltages up to 240V AC only)	601280240030	60.12.8.024.0030	<a href="#">Buy on EAN</a>
8-pin;Plug-in;AgNi;2CO 10A;lockable test btton+flag indicator	601280240040	60.12.8.024.0040	<a href="#">Buy on EAN</a>
8-pin;Plug-in;AgNi;2CO 10A;lockable test btton+flag indicator	601280240040PAS	60.12.8.024.0040PAS	<a href="#">Buy on EAN</a>
Lockable test button + LED (60.12/60.13 coil voltages up to 240V AC only)	601280240050	60.12.8.024.0050	<a href="#">Buy on EAN</a>
Lckble test btton+flag indicator+LED (60.12/60.13 coil voltages up to 240V AC only)	601280240054	60.12.8.024.0054	<a href="#">Buy on EAN</a>
Lckble test btton+flag indicator+LED (60.12/60.13 coil voltages up to 240V AC only)	601280240054PAS	60.12.8.024.0054PAS	<a href="#">Buy on EAN</a>
AgCdO contacts (60.12/60.13 only)	601280242000	60.12.8.024.2000	<a href="#">Buy on EAN</a>
AgCdO contacts (60.12/60.13 only)	601280242040	60.12.8.024.2040	<a href="#">Buy on EAN</a>
AgNi+Au contacts (60.12/60.13 only)	601280245000	60.12.8.024.5000	<a href="#">Buy on EAN</a>
AgNi+Au contacts (60.12/60.13 only)	601280245030	60.12.8.024.5030	<a href="#">Buy on EAN</a>
AgNi+Au contacts (60.12/60.13 only)	601280245040	60.12.8.024.5040	<a href="#">Buy on EAN</a>
General purpose relay	601280360000	60.12.8.036.0000	<a href="#">Buy on EAN</a>
8-pin;Plug-in;AgNi;2CO 10A;lockable test btton+flag indicator	601280360040	60.12.8.036.0040	<a href="#">Buy on EAN</a>
General purpose relay	601280480000	60.12.8.048.0000	<a href="#">Buy on EAN</a>
LED (60.12/60.13 coil voltages up to 240V AC only)	601280480030	60.12.8.048.0030	<a href="#">Buy on EAN</a>
8-pin;Plug-in;AgNi;2CO 10A;lockable test btton+flag indicator	601280480040	60.12.8.048.0040	<a href="#">Buy on EAN</a>
8-pin;Plug-in;AgNi;2CO 10A;lockable test btton+flag indicator	601280480040PAS	60.12.8.048.0040PAS	<a href="#">Buy on EAN</a>
Lockable test button + LED (60.12/60.13 coil voltages up to 240V AC only)	601280480050	60.12.8.048.0050	<a href="#">Buy on EAN</a>
Lckble test btton+flag indicator+LED (60.12/60.13 coil voltages up to 240V AC only)	601280480054	60.12.8.048.0054	<a href="#">Buy on EAN</a>
AgCdO contacts (60.12/60.13 only)	601280482000	60.12.8.048.2000	<a href="#">Buy on EAN</a>

AgCdO contacts (60.12/60.13 only)	601280482040	60.12.8.048.2040	<a href="#">Buy on EAN</a>
General purpose relay	601280600000	60.12.8.060.0000	<a href="#">Buy on EAN</a>
LED (60.12/60.13 coil voltages up to 240V AC only)	601280600030	60.12.8.060.0030	<a href="#">Buy on EAN</a>
8-pin;Plug-in;AgNi;2CO 10A;lockable test btton+flag indicator	601280600040	60.12.8.060.0040	<a href="#">Buy on EAN</a>
8-pin;Plug-in;AgNi;2CO 10A;lockable test btton+flag indicator	601280600040PAS	60.12.8.060.0040PAS	<a href="#">Buy on EAN</a>
Lockable test button + LED (60.12/60.13 coil voltages up to 240V AC only)	601280600050	60.12.8.060.0050	<a href="#">Buy on EAN</a>
AgNi+Au contacts (60.12/60.13 only)	601280605000	60.12.8.060.5000	<a href="#">Buy on EAN</a>
General purpose relay	601281100000	60.12.8.110.0000	<a href="#">Buy on EAN</a>
Flag indicator (60.12/60.13 only)	601281100020	60.12.8.110.0020	<a href="#">Buy on EAN</a>
LED (60.12/60.13 coil voltages up to 240V AC only)	601281100030	60.12.8.110.0030	<a href="#">Buy on EAN</a>
8-pin;Plug-in;AgNi;2CO 10A;lockable test btton+flag indicator	601281100040	60.12.8.110.0040	<a href="#">Buy on EAN</a>
8-pin;Plug-in;AgNi;2CO 10A;lockable test btton+flag indicator	601281100040PAS	60.12.8.110.0040PAS	<a href="#">Buy on EAN</a>
Lockable test button + LED (60.12/60.13 coil voltages up to 240V AC only)	601281100050	60.12.8.110.0050	<a href="#">Buy on EAN</a>
Lckble test btton+flag indicator+LED (60.12/60.13 coil voltages up to 240V AC only)	601281100054	60.12.8.110.0054	<a href="#">Buy on EAN</a>
Bifurcated contacts (60.12/60.13 only)	601281100240	60.12.8.110.0240	<a href="#">Buy on EAN</a>
AgCdO contacts (60.12/60.13 only)	601281102000	60.12.8.110.2000	<a href="#">Buy on EAN</a>
AgCdO contacts (60.12/60.13 only)	601281102030	60.12.8.110.2030	<a href="#">Buy on EAN</a>
AgCdO contacts (60.12/60.13 only)	601281102040	60.12.8.110.2040	<a href="#">Buy on EAN</a>
AgNi+Au contacts (60.12/60.13 only)	601281105000	60.12.8.110.5000	<a href="#">Buy on EAN</a>
AgNi+Au contacts (60.12/60.13 only)	601281105040	60.12.8.110.5040	<a href="#">Buy on EAN</a>
8-pin;Plug-in;AgNi;2CO 10A;lockable test btton+flag indicator	601281150040	60.12.8.115.0040	<a href="#">Buy on EAN</a>
General purpose relay	601281200000	60.12.8.120.0000	<a href="#">Buy on EAN</a>
LED (60.12/60.13 coil voltages up to 240V AC only)	601281200030	60.12.8.120.0030	<a href="#">Buy on EAN</a>

8-pin;Plug-in;AgNi;2CO 10A;lockable test btton+flag indicator	601281200040	60.12.8.120.0040	<a href="#">Buy on EAN</a>
8-pin;Plug-in;AgNi;2CO 10A;lockable test btton+flag indicator	601281200040PAS	60.12.8.120.0040PAS	<a href="#">Buy on EAN</a>
Lockable test button + LED (60.12/60.13 coil voltages up to 240V AC only)	601281200050	60.12.8.120.0050	<a href="#">Buy on EAN</a>
Lckble test btton+flag indicator+LED (60.12/60.13 coil voltages up to 240V AC only)	601281200054	60.12.8.120.0054	<a href="#">Buy on EAN</a>
AgCdO contacts (60.12/60.13 only)	601281202000	60.12.8.120.2000	<a href="#">Buy on EAN</a>
AgCdO contacts (60.12/60.13 only)	601281202030	60.12.8.120.2030	<a href="#">Buy on EAN</a>
AgCdO contacts (60.12/60.13 only)	601281202040	60.12.8.120.2040	<a href="#">Buy on EAN</a>
AgNi+Au contacts (60.12/60.13 only)	601281205040	60.12.8.120.5040	<a href="#">Buy on EAN</a>
AgNi+Au contacts (60.12/60.13 only)	601281205040PAS	60.12.8.120.5040PAS	<a href="#">Buy on EAN</a>
General purpose relay	601281250000	60.12.8.125.0000	<a href="#">Buy on EAN</a>
LED (60.12/60.13 coil voltages up to 240V AC only)	601281250030	60.12.8.125.0030	<a href="#">Buy on EAN</a>
8-pin;Plug-in;AgNi;2CO 10A;lockable test btton+flag indicator	601281250040	60.12.8.125.0040	<a href="#">Buy on EAN</a>
8-pin;Plug-in;AgNi;2CO 10A;lockable test btton+flag indicator	601281250040PAS	60.12.8.125.0040PAS	<a href="#">Buy on EAN</a>
AgCdO contacts (60.12/60.13 only)	601281252000	60.12.8.125.2000	<a href="#">Buy on EAN</a>
AgNi+Au contacts (60.12/60.13 only)	601281255000	60.12.8.125.5000	<a href="#">Buy on EAN</a>
AgNi+Au contacts (60.12/60.13 only)	601281255040	60.12.8.125.5040	<a href="#">Buy on EAN</a>
General purpose relay	601282300000	60.12.8.230.0000	<a href="#">Buy on EAN</a>
Flag indicator (60.12/60.13 only)	601282300020	60.12.8.230.0020	<a href="#">Buy on EAN</a>
LED (60.12/60.13 coil voltages up to 240V AC only)	601282300030	60.12.8.230.0030	<a href="#">Buy on EAN</a>
8-pin;Plug-in;AgNi;2CO 10A;lockable test btton+flag indicator	601282300040	60.12.8.230.0040	<a href="#">Buy on EAN</a>
8-pin;Plug-in;AgNi;2CO 10A;lockable test btton+flag indicator	601282300040PAS	60.12.8.230.0040PAS	<a href="#">Buy on EAN</a>
Lockable test button + LED (60.12/60.13 coil voltages up to 240V AC only)	601282300050	60.12.8.230.0050	<a href="#">Buy on EAN</a>
Lckble test btton+flag indicator+LED (60.12/60.13 coil voltages up to 240V AC only)	601282300054	60.12.8.230.0054	<a href="#">Buy on EAN</a>

Lckble test btton+flag indicator+LED (60.12/60.13 coil voltages up to 240V AC only)	601282300054PAS	60.12.8.230.0054PAS	<a href="#">Buy on EAN</a>
Bifurcated contacts (60.12/60.13 only)	601282300240	60.12.8.230.0240	<a href="#">Buy on EAN</a>
AgCdO contacts (60.12/60.13 only)	601282302000	60.12.8.230.2000	<a href="#">Buy on EAN</a>
AgCdO contacts (60.12/60.13 only)	601282302040	60.12.8.230.2040	<a href="#">Buy on EAN</a>
AgNi+Au contacts (60.12/60.13 only)	601282305000	60.12.8.230.5000	<a href="#">Buy on EAN</a>
AgNi+Au contacts (60.12/60.13 only)	601282305040	60.12.8.230.5040	<a href="#">Buy on EAN</a>
AgNi+Au contacts (60.12/60.13 only)	601282305040PAS	60.12.8.230.5040PAS	<a href="#">Buy on EAN</a>
General purpose relay	601282400000	60.12.8.240.0000	<a href="#">Buy on EAN</a>
LED (60.12/60.13 coil voltages up to 240V AC only)	601282400030	60.12.8.240.0030	<a href="#">Buy on EAN</a>
8-pin;Plug-in;AgNi;2CO 10A;lockable test btton+flag indicator	601282400040	60.12.8.240.0040	<a href="#">Buy on EAN</a>
8-pin;Plug-in;AgNi;2CO 10A;lockable test btton+flag indicator	601282400040PAS	60.12.8.240.0040PAS	<a href="#">Buy on EAN</a>
Lockable test button + LED (60.12/60.13 coil voltages up to 240V AC only)	601282400050	60.12.8.240.0050	<a href="#">Buy on EAN</a>
AgCdO contacts (60.12/60.13 only)	601282402000	60.12.8.240.2000	<a href="#">Buy on EAN</a>
AgCdO contacts (60.12/60.13 only)	601282402040	60.12.8.240.2040	<a href="#">Buy on EAN</a>
AgNi+Au contacts (60.12/60.13 only)	601282405000	60.12.8.240.5000	<a href="#">Buy on EAN</a>
AgNi+Au contacts (60.12/60.13 only)	601282405040	60.12.8.240.5040	<a href="#">Buy on EAN</a>
400VAC coil; (add to 1st column price)	601284000040	60.12.8.400.0040	<a href="#">Buy on EAN</a>
400VAC coil; (add to 1st column price)	601284000040PAS	60.12.8.400.0040PAS	<a href="#">Buy on EAN</a>
General purpose relay	601290060000	60.12.9.006.0000	<a href="#">Buy on EAN</a>
8-pin;Plug-in;AgNi;2CO 10A;lockable test btton+flag indicator	601290060040	60.12.9.006.0040	<a href="#">Buy on EAN</a>
8-pin;Plug-in;AgNi;2CO 10A;lockable test btton+flag indicator	601290060040PAS	60.12.9.006.0040PAS	<a href="#">Buy on EAN</a>
General purpose relay	601290120000	60.12.9.012.0000	<a href="#">Buy on EAN</a>
8-pin;Plug-in;AgNi;2CO 10A;lockable test btton+flag indicator	601290120040	60.12.9.012.0040	<a href="#">Buy on EAN</a>
8-pin;Plug-in;AgNi;2CO 10A;lockable test btton+flag indicator	601290120040PAS	60.12.9.012.0040PAS	<a href="#">Buy on EAN</a>

LED + diode; positive to pin 2 (60.12/60.13 coil voltages up to 125V DC only)	601290120060	60.12.9.012.0060	<a href="#">Buy on EAN</a>
Lockable test button + LED + diode; positive to pin 2 (60.12/60.13 coil voltages up to 125V DC only)	601290120070	60.12.9.012.0070	<a href="#">Buy on EAN</a>
Lockable test button + flag indicator + LED + diode; positive to pin 2 (60.12/60.13 coil voltages up to 125V DC only)	601290120074	60.12.9.012.0074	<a href="#">Buy on EAN</a>
AgCdO contacts (60.12/60.13 only)	601290122000	60.12.9.012.2000	<a href="#">Buy on EAN</a>
AgCdO contacts (60.12/60.13 only)	601290122040	60.12.9.012.2040	<a href="#">Buy on EAN</a>
AgNi+Au contacts (60.12/60.13 only)	601290125040	60.12.9.012.5040	<a href="#">Buy on EAN</a>
AgNi+Au contacts (60.12/60.13 only)	601290125040PAS	60.12.9.012.5040PAS	<a href="#">Buy on EAN</a>
General purpose relay	601290240000	60.12.9.024.0000	<a href="#">Buy on EAN</a>
8-pin;Plug-in;AgNi;2CO 10A;lockable test button+flag indicator	601290240040	60.12.9.024.0040	<a href="#">Buy on EAN</a>
8-pin;Plug-in;AgNi;2CO 10A;lockable test button+flag indicator	601290240040PAS	60.12.9.024.0040PAS	<a href="#">Buy on EAN</a>
LED + diode; positive to pin 2 (60.12/60.13 coil voltages up to 125V DC only)	601290240060	60.12.9.024.0060	<a href="#">Buy on EAN</a>
Lockable test button + LED + diode; positive to pin 2 (60.12/60.13 coil voltages up to 125V DC only)	601290240070	60.12.9.024.0070	<a href="#">Buy on EAN</a>
Lockable test button + flag indicator + LED + diode; positive to pin 2 (60.12/60.13 coil voltages up to 125V DC only)	601290240074	60.12.9.024.0074	<a href="#">Buy on EAN</a>
Lockable test button + flag indicator + LED + diode; positive to pin 2 (60.12/60.13 coil voltages up to 125V DC only)	601290240074PAS	60.12.9.024.0074PAS	<a href="#">Buy on EAN</a>
Bifurcated contacts (60.12/60.13 only)	601290240240	60.12.9.024.0240	<a href="#">Buy on EAN</a>
AgCdO contacts (60.12/60.13 only)	601290242000	60.12.9.024.2000	<a href="#">Buy on EAN</a>
AgCdO contacts (60.12/60.13 only)	601290242040	60.12.9.024.2040	<a href="#">Buy on EAN</a>
AgCdO contacts (60.12/60.13 only)	601290242070	60.12.9.024.2070	<a href="#">Buy on EAN</a>
AgCdO contacts (60.12/60.13 only)	601290242074	60.12.9.024.2074	<a href="#">Buy on EAN</a>
AgNi+Au contacts (60.12/60.13 only)	601290245000	60.12.9.024.5000	<a href="#">Buy on EAN</a>

AgNi+Au contacts (60.12/60.13 only)	601290245040	60.12.9.024.5040	<a href="#">Buy on EAN</a>
General purpose relay	601290360000	60.12.9.036.0000	<a href="#">Buy on EAN</a>
8-pin;Plug-in;AgNi;2CO 10A;lockable test btton+flag indicator	601290360040	60.12.9.036.0040	<a href="#">Buy on EAN</a>
General purpose relay	601290480000	60.12.9.048.0000	<a href="#">Buy on EAN</a>
8-pin;Plug-in;AgNi;2CO 10A;lockable test btton+flag indicator	601290480040	60.12.9.048.0040	<a href="#">Buy on EAN</a>
8-pin;Plug-in;AgNi;2CO 10A;lockable test btton+flag indicator	601290480040PAS	60.12.9.048.0040PAS	<a href="#">Buy on EAN</a>
LED + diode; positive to pin 2 (60.12/60.13 coil voltages up to 125V DC only)	601290480060	60.12.9.048.0060	<a href="#">Buy on EAN</a>
Lockable test button + LED + diode; positive to pin 2 (60.12/60.13 coil voltages up to 125V DC only)	601290480070	60.12.9.048.0070	<a href="#">Buy on EAN</a>
Lockable test button + flag indicator + LED + diode; positive to pin 2 (60.12/60.13 coil voltages up to 125V DC only)	601290480074	60.12.9.048.0074	<a href="#">Buy on EAN</a>
AgCdO contacts (60.12/60.13 only)	601290482000	60.12.9.048.2000	<a href="#">Buy on EAN</a>
AgCdO contacts (60.12/60.13 only)	601290482040	60.12.9.048.2040	<a href="#">Buy on EAN</a>
AgNi+Au contacts (60.12/60.13 only)	601290485040	60.12.9.048.5040	<a href="#">Buy on EAN</a>
General purpose relay	601290600000	60.12.9.060.0000	<a href="#">Buy on EAN</a>
8-pin;Plug-in;AgNi;2CO 10A;lockable test btton+flag indicator	601290600040	60.12.9.060.0040	<a href="#">Buy on EAN</a>
8-pin;Plug-in;AgNi;2CO 10A;lockable test btton+flag indicator	601290600040PAS	60.12.9.060.0040PAS	<a href="#">Buy on EAN</a>
LED + diode; positive to pin 2 (60.12/60.13 coil voltages up to 125V DC only)	601290600060	60.12.9.060.0060	<a href="#">Buy on EAN</a>
AgNi+Au contacts (60.12/60.13 only)	601290605040	60.12.9.060.5040	<a href="#">Buy on EAN</a>
General purpose relay	601290800000	60.12.9.080.0000	<a href="#">Buy on EAN</a>
8-pin;Plug-in;AgNi;2CO 10A;lockable test btton+flag indicator	601290800040	60.12.9.080.0040	<a href="#">Buy on EAN</a>
General purpose relay	601291100000	60.12.9.110.0000	<a href="#">Buy on EAN</a>
8-pin;Plug-in;AgNi;2CO 10A;lockable test btton+flag indicator	601291100040	60.12.9.110.0040	<a href="#">Buy on EAN</a>
8-pin;Plug-in;AgNi;2CO 10A;lockable test btton+flag indicator	601291100040PAS	60.12.9.110.0040PAS	<a href="#">Buy on EAN</a>



LED + diode; positive to pin 2 (60.12/60.13 coil voltages up to 125V DC only)	601291100060	60.12.9.110.0060	<a href="#">Buy on EAN</a>
Lockable test button + LED + diode; positive to pin 2 (60.12/60.13 coil voltages up to 125V DC only)	601291100070	60.12.9.110.0070	<a href="#">Buy on EAN</a>
Lockable test button + flag indicator + LED + diode; positive to pin 2 (60.12/60.13 coil voltages up to 125V DC only)	601291100074	60.12.9.110.0074	<a href="#">Buy on EAN</a>
AgCdO contacts (60.12/60.13 only)	601291102000	60.12.9.110.2000	<a href="#">Buy on EAN</a>
AgCdO contacts (60.12/60.13 only)	601291102040	60.12.9.110.2040	<a href="#">Buy on EAN</a>
AgNi+Au contacts (60.12/60.13 only)	601291105000	60.12.9.110.5000	<a href="#">Buy on EAN</a>
AgNi+Au contacts (60.12/60.13 only)	601291105040	60.12.9.110.5040	<a href="#">Buy on EAN</a>
125VDC coil (add to 1st column price)	601291250000	60.12.9.125.0000	<a href="#">Buy on EAN</a>
125VDC coil (add to 1st column price)	601291250040	60.12.9.125.0040	<a href="#">Buy on EAN</a>
125VDC coil (add to 1st column price)	601291250040PAS	60.12.9.125.0040PAS	<a href="#">Buy on EAN</a>
125VDC coil (add to 1st column price)	601291250060	60.12.9.125.0060	<a href="#">Buy on EAN</a>
125VDC coil (add to 1st column price)	601291255000	60.12.9.125.5000	<a href="#">Buy on EAN</a>
140,145VDC coil (add to 1st column price)	601291400000	60.12.9.140.0000	<a href="#">Buy on EAN</a>
140,145VDC coil (add to 1st column price)	601291400040	60.12.9.140.0040	<a href="#">Buy on EAN</a>
140,145VDC coil (add to 1st column price)	601291450000	60.12.9.145.0000	<a href="#">Buy on EAN</a>
140,145VDC coil (add to 1st column price)	601291450040	60.12.9.145.0040	<a href="#">Buy on EAN</a>
220VDC coil (add to 1st column price)	601292200000	60.12.9.220.0000	<a href="#">Buy on EAN</a>
220VDC coil (add to 1st column price)	601292200040	60.12.9.220.0040	<a href="#">Buy on EAN</a>
220VDC coil (add to 1st column price)	601292200040PAS	60.12.9.220.0040PAS	<a href="#">Buy on EAN</a>
Current sensing coil; (add to 1st column price)	601340110040	60.13.4.011.0040	<a href="#">Buy on EAN</a>
Current sensing coil; (add to 1st column price)	601340110040PAS	60.13.4.011.0040PAS	<a href="#">Buy on EAN</a>
Current sensing coil; (add to 1st column price)	601340120040	60.13.4.012.0040	<a href="#">Buy on EAN</a>

Current sensing coil; (add to 1st column price)	601340120040PAS	60.13.4.012.0040PAS	Buy on EAN
Current sensing coil; (add to 1st column price)	601340210040	60.13.4.021.0040	Buy on EAN
Current sensing coil; (add to 1st column price)	601340210040PAS	60.13.4.021.0040PAS	Buy on EAN
Current sensing coil; (add to 1st column price)	601340220040	60.13.4.022.0040	Buy on EAN
Current sensing coil; (add to 1st column price)	601340220040PAS	60.13.4.022.0040PAS	Buy on EAN
Current sensing coil; (add to 1st column price)	601340310040	60.13.4.031.0040	Buy on EAN
Current sensing coil; (add to 1st column price)	601340310040PAS	60.13.4.031.0040PAS	Buy on EAN
Current sensing coil; (add to 1st column price)	601340320040	60.13.4.032.0040	Buy on EAN
Current sensing coil; (add to 1st column price)	601340320040PAS	60.13.4.032.0040PAS	Buy on EAN
Current sensing coil; (add to 1st column price)	601340410040	60.13.4.041.0040	Buy on EAN
Current sensing coil; (add to 1st column price)	601340410040PAS	60.13.4.041.0040PAS	Buy on EAN
Current sensing coil; (add to 1st column price)	601340420040	60.13.4.042.0040	Buy on EAN
Current sensing coil; (add to 1st column price)	601340420040PAS	60.13.4.042.0040PAS	Buy on EAN
Current sensing coil; (add to 1st column price)	601340510040	60.13.4.051.0040	Buy on EAN
Current sensing coil; (add to 1st column price)	601340510040PAS	60.13.4.051.0040PAS	Buy on EAN
Current sensing coil; (add to 1st column price)	601340520040	60.13.4.052.0040	Buy on EAN
Current sensing coil; (add to 1st column price)	601340520040PAS	60.13.4.052.0040PAS	Buy on EAN
Current sensing coil; (add to 1st column price)	601340610040	60.13.4.061.0040	Buy on EAN
Current sensing coil; (add to 1st column price)	601340610040PAS	60.13.4.061.0040PAS	Buy on EAN
Current sensing coil; (add to 1st column price)	601340620040	60.13.4.062.0040	Buy on EAN
Current sensing coil; (add to 1st column price)	601340620040PAS	60.13.4.062.0040PAS	Buy on EAN
Current sensing coil; (add to 1st column price)	601340710040	60.13.4.071.0040	Buy on EAN
Current sensing coil; (add to 1st column price)	601340710040PAS	60.13.4.071.0040PAS	Buy on EAN

Current sensing coil; (add to 1st column price)	601340720040	60.13.4.072.0040	Buy on EAN
Current sensing coil; (add to 1st column price)	601340720040PAS	60.13.4.072.0040PAS	Buy on EAN
Current sensing coil; (add to 1st column price)	601340810040	60.13.4.081.0040	Buy on EAN
Current sensing coil; (add to 1st column price)	601340810040PAS	60.13.4.081.0040PAS	Buy on EAN
Current sensing coil; (add to 1st column price)	601340820040	60.13.4.082.0040	Buy on EAN
Current sensing coil; (add to 1st column price)	601340820040PAS	60.13.4.082.0040PAS	Buy on EAN
Current sensing coil; (add to 1st column price)	601340910040	60.13.4.091.0040	Buy on EAN
Current sensing coil; (add to 1st column price)	601340910040PAS	60.13.4.091.0040PAS	Buy on EAN
Current sensing coil; (add to 1st column price)	601340920040	60.13.4.092.0040	Buy on EAN
Current sensing coil; (add to 1st column price)	601340920040PAS	60.13.4.092.0040PAS	Buy on EAN
Current sensing coil; (add to 1st column price)	601341010040	60.13.4.101.0040	Buy on EAN
Current sensing coil; (add to 1st column price)	601341010040PAS	60.13.4.101.0040PAS	Buy on EAN
Current sensing coil; (add to 1st column price)	601341020040	60.13.4.102.0040	Buy on EAN
Current sensing coil; (add to 1st column price)	601341020040PAS	60.13.4.102.0040PAS	Buy on EAN
Current sensing coil; (add to 1st column price)	601341210040	60.13.4.121.0040	Buy on EAN
Current sensing coil; (add to 1st column price)	601341210040PAS	60.13.4.121.0040PAS	Buy on EAN
Current sensing coil; (add to 1st column price)	601341220040	60.13.4.122.0040	Buy on EAN
Current sensing coil; (add to 1st column price)	601341220040PAS	60.13.4.122.0040PAS	Buy on EAN
Current sensing coil; (add to 1st column price)	601341410040	60.13.4.141.0040	Buy on EAN
Current sensing coil; (add to 1st column price)	601341410040PAS	60.13.4.141.0040PAS	Buy on EAN
Current sensing coil; (add to 1st column price)	601341420040	60.13.4.142.0040	Buy on EAN
Current sensing coil; (add to 1st column price)	601341420040PAS	60.13.4.142.0040PAS	Buy on EAN
Current sensing coil; (add to 1st column price)	601341610040	60.13.4.161.0040	Buy on EAN

Current sensing coil; (add to 1st column price)	601341610040PAS	60.13.4.161.0040PAS	Buy on EAN
Current sensing coil; (add to 1st column price)	601341620040	60.13.4.162.0040	Buy on EAN
Current sensing coil; (add to 1st column price)	601341620040PAS	60.13.4.162.0040PAS	Buy on EAN
Current sensing coil; (add to 1st column price)	601341810040	60.13.4.181.0040	Buy on EAN
Current sensing coil; (add to 1st column price)	601341810040PAS	60.13.4.181.0040PAS	Buy on EAN
Current sensing coil; (add to 1st column price)	601341820040	60.13.4.182.0040	Buy on EAN
Current sensing coil; (add to 1st column price)	601341820040PAS	60.13.4.182.0040PAS	Buy on EAN
Current sensing coil; (add to 1st column price)	601342010040	60.13.4.201.0040	Buy on EAN
Current sensing coil; (add to 1st column price)	601342010040PAS	60.13.4.201.0040PAS	Buy on EAN
Current sensing coil; (add to 1st column price)	601342020040	60.13.4.202.0040	Buy on EAN
Current sensing coil; (add to 1st column price)	601342020040PAS	60.13.4.202.0040PAS	Buy on EAN
Current sensing coil; (add to 1st column price)	601342220040	60.13.4.222.0040	Buy on EAN
Current sensing coil; (add to 1st column price)	601342220040PAS	60.13.4.222.0040PAS	Buy on EAN
Current sensing coil; (add to 1st column price)	601342310040	60.13.4.231.0040	Buy on EAN
Current sensing coil; (add to 1st column price)	601342310040PAS	60.13.4.231.0040PAS	Buy on EAN
Current sensing coil; (add to 1st column price)	601342510040	60.13.4.251.0040	Buy on EAN
Current sensing coil; (add to 1st column price)	601342510040PAS	60.13.4.251.0040PAS	Buy on EAN
Current sensing coil; (add to 1st column price)	601342520040	60.13.4.252.0040	Buy on EAN
Current sensing coil; (add to 1st column price)	601342520040PAS	60.13.4.252.0040PAS	Buy on EAN
Current sensing coil; (add to 1st column price)	601342810040	60.13.4.281.0040	Buy on EAN
Current sensing coil; (add to 1st column price)	601342810040PAS	60.13.4.281.0040PAS	Buy on EAN
Current sensing coil; (add to 1st column price)	601342820040	60.13.4.282.0040	Buy on EAN
Current sensing coil; (add to 1st column price)	601342820040PAS	60.13.4.282.0040PAS	Buy on EAN

Current sensing coil; (add to 1st column price)	601343210040	60.13.4.321.0040	Buy on EAN
Current sensing coil; (add to 1st column price)	601343210040PAS	60.13.4.321.0040PAS	Buy on EAN
Current sensing coil; (add to 1st column price)	601343220040	60.13.4.322.0040	Buy on EAN
Current sensing coil; (add to 1st column price)	601343220040PAS	60.13.4.322.0040PAS	Buy on EAN
Current sensing coil; (add to 1st column price)	601343610040	60.13.4.361.0040	Buy on EAN
Current sensing coil; (add to 1st column price)	601343610040PAS	60.13.4.361.0040PAS	Buy on EAN
Current sensing coil; (add to 1st column price)	601343620040	60.13.4.362.0040	Buy on EAN
Current sensing coil; (add to 1st column price)	601343620040PAS	60.13.4.362.0040PAS	Buy on EAN
Current sensing coil; (add to 1st column price)	601344010040	60.13.4.401.0040	Buy on EAN
Current sensing coil; (add to 1st column price)	601344010040PAS	60.13.4.401.0040PAS	Buy on EAN
Current sensing coil; (add to 1st column price)	601344020040	60.13.4.402.0040	Buy on EAN
Current sensing coil; (add to 1st column price)	601344020040PAS	60.13.4.402.0040PAS	Buy on EAN
Current sensing coil; (add to 1st column price)	601344510040	60.13.4.451.0040	Buy on EAN
Current sensing coil; (add to 1st column price)	601344510040PAS	60.13.4.451.0040PAS	Buy on EAN
Current sensing coil; (add to 1st column price)	601344520040	60.13.4.452.0040	Buy on EAN
Current sensing coil; (add to 1st column price)	601344520040PAS	60.13.4.452.0040PAS	Buy on EAN
Current sensing coil; (add to 1st column price)	601345010040	60.13.4.501.0040	Buy on EAN
Current sensing coil; (add to 1st column price)	601345010040PAS	60.13.4.501.0040PAS	Buy on EAN
Current sensing coil; (add to 1st column price)	601345020040	60.13.4.502.0040	Buy on EAN
Current sensing coil; (add to 1st column price)	601345020040PAS	60.13.4.502.0040PAS	Buy on EAN
11-pin;Plug-in;AgNi;3CO 10A;lockable test btton+flag indictr	601380060040	60.13.8.006.0040	Buy on EAN
11-pin;Plug-in;AgNi;3CO 10A;lockable test btton+flag indictr	601380060040PAS	60.13.8.006.0040PAS	Buy on EAN
Lckble test btton+flag indicator+LED (60.12/60.13 coil voltages up to 240V AC only)	601380060054	60.13.8.006.0054	Buy on EAN

AgCdO contacts (60.12/60.13 only)	601380062040	60.13.8.006.2040	<a href="#">Buy on EAN</a>
AgNi+Au contacts (60.12/60.13 only)	601380065040	60.13.8.006.5040	<a href="#">Buy on EAN</a>
General purpose relay	601380120000	60.13.8.012.0000	<a href="#">Buy on EAN</a>
Flag indicator (60.12/60.13 only)	601380120020	60.13.8.012.0020	<a href="#">Buy on EAN</a>
LED (60.12/60.13 coil voltages up to 240V AC only)	601380120030	60.13.8.012.0030	<a href="#">Buy on EAN</a>
11-pin;Plug-in;AgNi;3CO 10A;lockable test btton+flag indictr	601380120040	60.13.8.012.0040	<a href="#">Buy on EAN</a>
11-pin;Plug-in;AgNi;3CO 10A;lockable test btton+flag indictr	601380120040PAS	60.13.8.012.0040PAS	<a href="#">Buy on EAN</a>
Lockable test button + LED (60.12/60.13 coil voltages up to 240V AC only)	601380120050	60.13.8.012.0050	<a href="#">Buy on EAN</a>
Lckble test btton+flag indicator+LED (60.12/60.13 coil voltages up to 240V AC only)	601380120054	60.13.8.012.0054	<a href="#">Buy on EAN</a>
Bifurcated contacts (60.12/60.13 only)	601380120240	60.13.8.012.0240	<a href="#">Buy on EAN</a>
AgCdO contacts (60.12/60.13 only)	601380122000	60.13.8.012.2000	<a href="#">Buy on EAN</a>
AgCdO contacts (60.12/60.13 only)	601380122030	60.13.8.012.2030	<a href="#">Buy on EAN</a>
AgCdO contacts (60.12/60.13 only)	601380122050	60.13.8.012.2050	<a href="#">Buy on EAN</a>
AgNi+Au contacts (60.12/60.13 only)	601380125040	60.13.8.012.5040	<a href="#">Buy on EAN</a>
AgNi+Au contacts (60.12/60.13 only)	601380125050	60.13.8.012.5050	<a href="#">Buy on EAN</a>
AgNi+Au contacts (60.12/60.13 only)	601380125240	60.13.8.012.5240	<a href="#">Buy on EAN</a>
General purpose relay	601380240000	60.13.8.024.0000	<a href="#">Buy on EAN</a>
Flag indicator (60.12/60.13 only)	601380240020	60.13.8.024.0020	<a href="#">Buy on EAN</a>
LED (60.12/60.13 coil voltages up to 240V AC only)	601380240030	60.13.8.024.0030	<a href="#">Buy on EAN</a>
11-pin;Plug-in;AgNi;3CO 10A;lockable test btton+flag indictr	601380240040	60.13.8.024.0040	<a href="#">Buy on EAN</a>
11-pin;Plug-in;AgNi;3CO 10A;lockable test btton+flag indictr	601380240040PAS	60.13.8.024.0040PAS	<a href="#">Buy on EAN</a>
Lockable test button + LED (60.12/60.13 coil voltages up to 240V AC only)	601380240050	60.13.8.024.0050	<a href="#">Buy on EAN</a>
Lckble test btton+flag indicator+LED (60.12/60.13 coil voltages up to 240V AC only)	601380240054	60.13.8.024.0054	<a href="#">Buy on EAN</a>

Lckble test btton+flag indicator+LED (60.12/60.13 coil voltages up to 240V AC only)	601380240054PAS	60.13.8.024.0054PAS	<a href="#">Buy on EAN</a>
Bifurcated contacts (60.12/60.13 only)	601380240240	60.13.8.024.0240	<a href="#">Buy on EAN</a>
AgCdO contacts (60.12/60.13 only)	601380242000	60.13.8.024.2000	<a href="#">Buy on EAN</a>
AgCdO contacts (60.12/60.13 only)	601380242020	60.13.8.024.2020	<a href="#">Buy on EAN</a>
AgCdO contacts (60.12/60.13 only)	601380242030	60.13.8.024.2030	<a href="#">Buy on EAN</a>
AgCdO contacts (60.12/60.13 only)	601380242040	60.13.8.024.2040	<a href="#">Buy on EAN</a>
AgCdO contacts (60.12/60.13 only)	601380242050	60.13.8.024.2050	<a href="#">Buy on EAN</a>
AgCdO contacts (60.12/60.13 only)	601380242054	60.13.8.024.2054	<a href="#">Buy on EAN</a>
AgNi+Au contacts (60.12/60.13 only)	601380245000	60.13.8.024.5000	<a href="#">Buy on EAN</a>
AgNi+Au contacts (60.12/60.13 only)	601380245040	60.13.8.024.5040	<a href="#">Buy on EAN</a>
AgNi+Au contacts (60.12/60.13 only)	601380245050	60.13.8.024.5050	<a href="#">Buy on EAN</a>
AgNi+Au contacts (60.12/60.13 only)	601380245054	60.13.8.024.5054	<a href="#">Buy on EAN</a>
AgNi+Au contacts (60.12/60.13 only)	601380245240	60.13.8.024.5240	<a href="#">Buy on EAN</a>
AgNi+Au contacts (60.12/60.13 only)	601380245250	60.13.8.024.5250	<a href="#">Buy on EAN</a>
General purpose relay	601380360000	60.13.8.036.0000	<a href="#">Buy on EAN</a>
11-pin;Plug-in;AgNi;3CO 10A;lockable test btton+flag indictr	601380360040	60.13.8.036.0040	<a href="#">Buy on EAN</a>
General purpose relay	601380480000	60.13.8.048.0000	<a href="#">Buy on EAN</a>
LED (60.12/60.13 coil voltages up to 240V AC only)	601380480030	60.13.8.048.0030	<a href="#">Buy on EAN</a>
11-pin;Plug-in;AgNi;3CO 10A;lockable test btton+flag indictr	601380480040	60.13.8.048.0040	<a href="#">Buy on EAN</a>
11-pin;Plug-in;AgNi;3CO 10A;lockable test btton+flag indictr	601380480040PAS	60.13.8.048.0040PAS	<a href="#">Buy on EAN</a>
Lockable test button + LED (60.12/60.13 coil voltages up to 240V AC only)	601380480050	60.13.8.048.0050	<a href="#">Buy on EAN</a>
Lckble test btton+flag indicator+LED (60.12/60.13 coil voltages up to 240V AC only)	601380480054	60.13.8.048.0054	<a href="#">Buy on EAN</a>
AgCdO contacts (60.12/60.13 only)	601380482000	60.13.8.048.2000	<a href="#">Buy on EAN</a>
AgCdO contacts (60.12/60.13 only)	601380482040	60.13.8.048.2040	<a href="#">Buy on EAN</a>

AgNi+Au contacts (60.12/60.13 only)	601380485000	60.13.8.048.5000	<a href="#">Buy on EAN</a>
AgNi+Au contacts (60.12/60.13 only)	601380485040	60.13.8.048.5040	<a href="#">Buy on EAN</a>
AgNi+Au contacts (60.12/60.13 only)	601380485050	60.13.8.048.5050	<a href="#">Buy on EAN</a>
General purpose relay	601380600000	60.13.8.060.0000	<a href="#">Buy on EAN</a>
LED (60.12/60.13 coil voltages up to 240V AC only)	601380600030	60.13.8.060.0030	<a href="#">Buy on EAN</a>
11-pin;Plug-in;AgNi;3CO 10A;lockable test btton+flag indictr	601380600040	60.13.8.060.0040	<a href="#">Buy on EAN</a>
11-pin;Plug-in;AgNi;3CO 10A;lockable test btton+flag indictr	601380600040PAS	60.13.8.060.0040PAS	<a href="#">Buy on EAN</a>
Lckble test btton+flag indicator+LED (60.12/60.13 coil voltages up to 240V AC only)	601380600054	60.13.8.060.0054	<a href="#">Buy on EAN</a>
AgCdO contacts (60.12/60.13 only)	601380602000	60.13.8.060.2000	<a href="#">Buy on EAN</a>
AgNi+Au contacts (60.12/60.13 only)	601380605040	60.13.8.060.5040	<a href="#">Buy on EAN</a>
General purpose relay	601381100000	60.13.8.110.0000	<a href="#">Buy on EAN</a>
Flag indicator (60.12/60.13 only)	601381100020	60.13.8.110.0020	<a href="#">Buy on EAN</a>
LED (60.12/60.13 coil voltages up to 240V AC only)	601381100030	60.13.8.110.0030	<a href="#">Buy on EAN</a>
11-pin;Plug-in;AgNi;3CO 10A;lockable test btton+flag indictr	601381100040	60.13.8.110.0040	<a href="#">Buy on EAN</a>
11-pin;Plug-in;AgNi;3CO 10A;lockable test btton+flag indictr	601381100040PAS	60.13.8.110.0040PAS	<a href="#">Buy on EAN</a>
Lockable test button + LED (60.12/60.13 coil voltages up to 240V AC only)	601381100050	60.13.8.110.0050	<a href="#">Buy on EAN</a>
Lckble test btton+flag indicator+LED (60.12/60.13 coil voltages up to 240V AC only)	601381100054	60.13.8.110.0054	<a href="#">Buy on EAN</a>
Bifurcated contacts (60.12/60.13 only)	601381100240	60.13.8.110.0240	<a href="#">Buy on EAN</a>
Bifurcated contacts (60.12/60.13 only)	601381100250	60.13.8.110.0250	<a href="#">Buy on EAN</a>
AgCdO contacts (60.12/60.13 only)	601381102000	60.13.8.110.2000	<a href="#">Buy on EAN</a>
AgCdO contacts (60.12/60.13 only)	601381102020	60.13.8.110.2020	<a href="#">Buy on EAN</a>
AgCdO contacts (60.12/60.13 only)	601381102030	60.13.8.110.2030	<a href="#">Buy on EAN</a>
AgCdO contacts (60.12/60.13 only)	601381102040	60.13.8.110.2040	<a href="#">Buy on EAN</a>



AgCdO contacts (60.12/60.13 only)	601381102050	60.13.8.110.2050	<a href="#">Buy on EAN</a>
AgCdO contacts (60.12/60.13 only)	601381102054	60.13.8.110.2054	<a href="#">Buy on EAN</a>
AgNi+Au contacts (60.12/60.13 only)	601381105000	60.13.8.110.5000	<a href="#">Buy on EAN</a>
AgNi+Au contacts (60.12/60.13 only)	601381105030	60.13.8.110.5030	<a href="#">Buy on EAN</a>
AgNi+Au contacts (60.12/60.13 only)	601381105040	60.13.8.110.5040	<a href="#">Buy on EAN</a>
AgNi+Au contacts (60.12/60.13 only)	601381105050	60.13.8.110.5050	<a href="#">Buy on EAN</a>
AgNi+Au contacts (60.12/60.13 only)	601381105054	60.13.8.110.5054	<a href="#">Buy on EAN</a>
General purpose relay	601381150000	60.13.8.115.0000	<a href="#">Buy on EAN</a>
11-pin;Plug-in;AgNi;3CO 10A;lockable test btton+flag indictr	601381150040	60.13.8.115.0040	<a href="#">Buy on EAN</a>
Bifurcated contacts (60.12/60.13 only)	601381150240	60.13.8.115.0240	<a href="#">Buy on EAN</a>
General purpose relay	601381200000	60.13.8.120.0000	<a href="#">Buy on EAN</a>
LED (60.12/60.13 coil voltages up to 240V AC only)	601381200030	60.13.8.120.0030	<a href="#">Buy on EAN</a>
11-pin;Plug-in;AgNi;3CO 10A;lockable test btton+flag indictr	601381200040	60.13.8.120.0040	<a href="#">Buy on EAN</a>
11-pin;Plug-in;AgNi;3CO 10A;lockable test btton+flag indictr	601381200040PAS	60.13.8.120.0040PAS	<a href="#">Buy on EAN</a>
Lockable test button + LED (60.12/60.13 coil voltages up to 240V AC only)	601381200050	60.13.8.120.0050	<a href="#">Buy on EAN</a>
Lckble test btton+flag indicator+LED (60.12/60.13 coil voltages up to 240V AC only)	601381200054	60.13.8.120.0054	<a href="#">Buy on EAN</a>
Bifurcated contacts (60.12/60.13 only)	601381200240	60.13.8.120.0240	<a href="#">Buy on EAN</a>
Bifurcated contacts (60.12/60.13 only)	601381200250	60.13.8.120.0250	<a href="#">Buy on EAN</a>
AgCdO contacts (60.12/60.13 only)	601381202000	60.13.8.120.2000	<a href="#">Buy on EAN</a>
AgCdO contacts (60.12/60.13 only)	601381202030	60.13.8.120.2030	<a href="#">Buy on EAN</a>
AgCdO contacts (60.12/60.13 only)	601381202040	60.13.8.120.2040	<a href="#">Buy on EAN</a>
AgNi+Au contacts (60.12/60.13 only)	601381205000	60.13.8.120.5000	<a href="#">Buy on EAN</a>
AgNi+Au contacts (60.12/60.13 only)	601381205040	60.13.8.120.5040	<a href="#">Buy on EAN</a>
AgNi+Au contacts (60.12/60.13 only)	601381205050	60.13.8.120.5050	<a href="#">Buy on EAN</a>

General purpose relay	601381250000	60.13.8.125.0000	<a href="#">Buy on EAN</a>
Flag indicator (60.12/60.13 only)	601381250020	60.13.8.125.0020	<a href="#">Buy on EAN</a>
LED (60.12/60.13 coil voltages up to 240V AC only)	601381250030	60.13.8.125.0030	<a href="#">Buy on EAN</a>
11-pin;Plug-in;AgNi;3CO 10A;lockable test btton+flag indictr	601381250040	60.13.8.125.0040	<a href="#">Buy on EAN</a>
11-pin;Plug-in;AgNi;3CO 10A;lockable test btton+flag indictr	601381250040PAS	60.13.8.125.0040PAS	<a href="#">Buy on EAN</a>
Lockable test button + LED (60.12/60.13 coil voltages up to 240V AC only)	601381250050	60.13.8.125.0050	<a href="#">Buy on EAN</a>
AgCdO contacts (60.12/60.13 only)	601381252000	60.13.8.125.2000	<a href="#">Buy on EAN</a>
AgCdO contacts (60.12/60.13 only)	601381252040	60.13.8.125.2040	<a href="#">Buy on EAN</a>
AgNi+Au contacts (60.12/60.13 only)	601381255040	60.13.8.125.5040	<a href="#">Buy on EAN</a>
AgNi+Au contacts (60.12/60.13 only)	601381255050	60.13.8.125.5050	<a href="#">Buy on EAN</a>
General purpose relay	601382300000	60.13.8.230.0000	<a href="#">Buy on EAN</a>
Flag indicator (60.12/60.13 only)	601382300020	60.13.8.230.0020	<a href="#">Buy on EAN</a>
LED (60.12/60.13 coil voltages up to 240V AC only)	601382300030	60.13.8.230.0030	<a href="#">Buy on EAN</a>
LED (60.12/60.13 coil voltages up to 240V AC only)	601382300030PAS	60.13.8.230.0030PAS	<a href="#">Buy on EAN</a>
11-pin;Plug-in;AgNi;3CO 10A;lockable test btton+flag indictr	601382300040	60.13.8.230.0040	<a href="#">Buy on EAN</a>
11-pin;Plug-in;AgNi;3CO 10A;lockable test btton+flag indictr	601382300040PAS	60.13.8.230.0040PAS	<a href="#">Buy on EAN</a>
Lockable test button + LED (60.12/60.13 coil voltages up to 240V AC only)	601382300050	60.13.8.230.0050	<a href="#">Buy on EAN</a>
Lckble test btton+flag indicator+LED (60.12/60.13 coil voltages up to 240V AC only)	601382300054	60.13.8.230.0054	<a href="#">Buy on EAN</a>
Lckble test btton+flag indicator+LED (60.12/60.13 coil voltages up to 240V AC only)	601382300054PAS	60.13.8.230.0054PAS	<a href="#">Buy on EAN</a>
Bifurcated contacts (60.12/60.13 only)	601382300200	60.13.8.230.0200	<a href="#">Buy on EAN</a>
Bifurcated contacts (60.12/60.13 only)	601382300240	60.13.8.230.0240	<a href="#">Buy on EAN</a>
Bifurcated contacts (60.12/60.13 only)	601382300254	60.13.8.230.0254	<a href="#">Buy on EAN</a>

AgCdO contacts (60.12/60.13 only)	601382302000	60.13.8.230.2000	<a href="#">Buy on EAN</a>
AgCdO contacts (60.12/60.13 only)	601382302040	60.13.8.230.2040	<a href="#">Buy on EAN</a>
AgCdO contacts (60.12/60.13 only)	601382302050	60.13.8.230.2050	<a href="#">Buy on EAN</a>
AgCdO contacts (60.12/60.13 only)	601382302054	60.13.8.230.2054	<a href="#">Buy on EAN</a>
AgNi+Au contacts (60.12/60.13 only)	601382305000	60.13.8.230.5000	<a href="#">Buy on EAN</a>
AgNi+Au contacts (60.12/60.13 only)	601382305020	60.13.8.230.5020	<a href="#">Buy on EAN</a>
AgNi+Au contacts (60.12/60.13 only)	601382305030	60.13.8.230.5030	<a href="#">Buy on EAN</a>
AgNi+Au contacts (60.12/60.13 only)	601382305040	60.13.8.230.5040	<a href="#">Buy on EAN</a>
AgNi+Au contacts (60.12/60.13 only)	601382305050	60.13.8.230.5050	<a href="#">Buy on EAN</a>
AgNi+Au contacts (60.12/60.13 only)	601382305054	60.13.8.230.5054	<a href="#">Buy on EAN</a>
General purpose relay	601382400000	60.13.8.240.0000	<a href="#">Buy on EAN</a>
Flag indicator (60.12/60.13 only)	601382400020	60.13.8.240.0020	<a href="#">Buy on EAN</a>
LED (60.12/60.13 coil voltages up to 240V AC only)	601382400030	60.13.8.240.0030	<a href="#">Buy on EAN</a>
11-pin;Plug-in;AgNi;3CO 10A;lockable test btton+flag indictr	601382400040	60.13.8.240.0040	<a href="#">Buy on EAN</a>
Lockable test button + LED (60.12/60.13 coil voltages up to 240V AC only)	601382400050	60.13.8.240.0050	<a href="#">Buy on EAN</a>
Lckble test btton+flag indicator+LED (60.12/60.13 coil voltages up to 240V AC only)	601382400054	60.13.8.240.0054	<a href="#">Buy on EAN</a>
Bifurcated contacts (60.12/60.13 only)	601382400240	60.13.8.240.0240	<a href="#">Buy on EAN</a>
AgCdO contacts (60.12/60.13 only)	601382402040	60.13.8.240.2040	<a href="#">Buy on EAN</a>
AgCdO contacts (60.12/60.13 only)	601382402050	60.13.8.240.2050	<a href="#">Buy on EAN</a>
AgNi+Au contacts (60.12/60.13 only)	601382405000	60.13.8.240.5000	<a href="#">Buy on EAN</a>
AgNi+Au contacts (60.12/60.13 only)	601382405030	60.13.8.240.5030	<a href="#">Buy on EAN</a>
AgNi+Au contacts (60.12/60.13 only)	601382405040	60.13.8.240.5040	<a href="#">Buy on EAN</a>
AgNi+Au contacts (60.12/60.13 only)	601382405054	60.13.8.240.5054	<a href="#">Buy on EAN</a>
400VAC coil; (add to 1st column price)	601384000040	60.13.8.400.0040	<a href="#">Buy on EAN</a>

General purpose relay	601390060000	60.13.9.006.0000	<a href="#">Buy on EAN</a>
Flag indicator (60.12/60.13 only)	601390060020	60.13.9.006.0020	<a href="#">Buy on EAN</a>
11-pin;Plug-in;AgNi;3CO 10A;lockable test btton+flag indictr	601390060040	60.13.9.006.0040	<a href="#">Buy on EAN</a>
11-pin;Plug-in;AgNi;3CO 10A;lockable test btton+flag indictr	601390060040PAS	60.13.9.006.0040PAS	<a href="#">Buy on EAN</a>
Lockable test button + flag indicator + LED + diode; positive to pin 2 (60.12/60.13 coil voltages up to 125V DC only)	601390060074	60.13.9.006.0074	<a href="#">Buy on EAN</a>
AgCdO contacts (60.12/60.13 only)	601390062040	60.13.9.006.2040	<a href="#">Buy on EAN</a>
AgNi+Au contacts (60.12/60.13 only)	601390065040	60.13.9.006.5040	<a href="#">Buy on EAN</a>
General purpose relay	601390120000	60.13.9.012.0000	<a href="#">Buy on EAN</a>
Flag indicator (60.12/60.13 only)	601390120020	60.13.9.012.0020	<a href="#">Buy on EAN</a>
11-pin;Plug-in;AgNi;3CO 10A;lockable test btton+flag indictr	601390120040	60.13.9.012.0040	<a href="#">Buy on EAN</a>
11-pin;Plug-in;AgNi;3CO 10A;lockable test btton+flag indictr	601390120040PAS	60.13.9.012.0040PAS	<a href="#">Buy on EAN</a>
LED + diode; positive to pin 2 (60.12/60.13 coil voltages up to 125V DC only)	601390120060	60.13.9.012.0060	<a href="#">Buy on EAN</a>
Lockable test button + LED + diode; positive to pin 2 (60.12/60.13 coil voltages up to 125V DC only)	601390120070	60.13.9.012.0070	<a href="#">Buy on EAN</a>
Lockable test button + LED + diode; positive to pin 2 (60.12/60.13 coil voltages up to 125V DC only)	601390120070PAS	60.13.9.012.0070PAS	<a href="#">Buy on EAN</a>
Lockable test button + flag indicator + LED + diode; positive to pin 2 (60.12/60.13 coil voltages up to 125V DC only)	601390120074	60.13.9.012.0074	<a href="#">Buy on EAN</a>
Bifurcated contacts (60.12/60.13 only)	601390120240	60.13.9.012.0240	<a href="#">Buy on EAN</a>
AgCdO contacts (60.12/60.13 only)	601390122000	60.13.9.012.2000	<a href="#">Buy on EAN</a>
AgCdO contacts (60.12/60.13 only)	601390122040	60.13.9.012.2040	<a href="#">Buy on EAN</a>
AgCdO contacts (60.12/60.13 only)	601390122070	60.13.9.012.2070	<a href="#">Buy on EAN</a>
AgNi+Au contacts (60.12/60.13 only)	601390125000	60.13.9.012.5000	<a href="#">Buy on EAN</a>
AgNi+Au contacts (60.12/60.13 only)	601390125040	60.13.9.012.5040	<a href="#">Buy on EAN</a>
AgNi+Au contacts (60.12/60.13 only)	601390125070	60.13.9.012.5070	<a href="#">Buy on EAN</a>

AgNi+Au contacts (60.12/60.13 only)	601390125074	60.13.9.012.5074	<a href="#">Buy on EAN</a>
AgNi+Au contacts (60.12/60.13 only)	601390125240	60.13.9.012.5240	<a href="#">Buy on EAN</a>
AgNi+Au contacts (60.12/60.13 only)	601390125274	60.13.9.012.5274	<a href="#">Buy on EAN</a>
General purpose relay	601390240000	60.13.9.024.0000	<a href="#">Buy on EAN</a>
Flag indicator (60.12/60.13 only)	601390240020	60.13.9.024.0020	<a href="#">Buy on EAN</a>
11-pin;Plug-in;AgNi;3CO 10A;lockable test btton+flag indictr	601390240040	60.13.9.024.0040	<a href="#">Buy on EAN</a>
11-pin;Plug-in;AgNi;3CO 10A;lockable test btton+flag indictr	601390240040PAS	60.13.9.024.0040PAS	<a href="#">Buy on EAN</a>
LED + diode; positive to pin 2 (60.12/60.13 coil voltages up to 125V DC only)	601390240060	60.13.9.024.0060	<a href="#">Buy on EAN</a>
Lockable test button + LED + diode; positive to pin 2 (60.12/60.13 coil voltages up to 125V DC only)	601390240070	60.13.9.024.0070	<a href="#">Buy on EAN</a>
Lockable test button + LED + diode; positive to pin 2 (60.12/60.13 coil voltages up to 125V DC only)	601390240070PAS	60.13.9.024.0070PAS	<a href="#">Buy on EAN</a>
Lockable test button + flag indicator + LED + diode; positive to pin 2 (60.12/60.13 coil voltages up to 125V DC only)	601390240074	60.13.9.024.0074	<a href="#">Buy on EAN</a>
Lockable test button + flag indicator + LED + diode; positive to pin 2 (60.12/60.13 coil voltages up to 125V DC only)	601390240074PAS	60.13.9.024.0074PAS	<a href="#">Buy on EAN</a>
Bifurcated contacts (60.12/60.13 only)	601390240200	60.13.9.024.0200	<a href="#">Buy on EAN</a>
Bifurcated contacts (60.12/60.13 only)	601390240240	60.13.9.024.0240	<a href="#">Buy on EAN</a>
Bifurcated contacts (60.12/60.13 only)	601390240270	60.13.9.024.0270	<a href="#">Buy on EAN</a>
Bifurcated contacts (60.12/60.13 only)	601390240274	60.13.9.024.0274	<a href="#">Buy on EAN</a>
AgCdO contacts (60.12/60.13 only)	601390242000	60.13.9.024.2000	<a href="#">Buy on EAN</a>
AgCdO contacts (60.12/60.13 only)	601390242020	60.13.9.024.2020	<a href="#">Buy on EAN</a>
AgCdO contacts (60.12/60.13 only)	601390242040	60.13.9.024.2040	<a href="#">Buy on EAN</a>
AgCdO contacts (60.12/60.13 only)	601390242070	60.13.9.024.2070	<a href="#">Buy on EAN</a>
AgCdO contacts (60.12/60.13 only)	601390242074	60.13.9.024.2074	<a href="#">Buy on EAN</a>
AgNi+Au contacts (60.12/60.13 only)	601390245000	60.13.9.024.5000	<a href="#">Buy on EAN</a>

AgNi+Au contacts (60.12/60.13 only)	601390245020	60.13.9.024.5020	<a href="#">Buy on EAN</a>
AgNi+Au contacts (60.12/60.13 only)	601390245040	60.13.9.024.5040	<a href="#">Buy on EAN</a>
AgNi+Au contacts (60.12/60.13 only)	601390245060	60.13.9.024.5060	<a href="#">Buy on EAN</a>
AgNi+Au contacts (60.12/60.13 only)	601390245070	60.13.9.024.5070	<a href="#">Buy on EAN</a>
AgNi+Au contacts (60.12/60.13 only)	601390245074	60.13.9.024.5074	<a href="#">Buy on EAN</a>
AgNi+Au contacts (60.12/60.13 only)	601390245240	60.13.9.024.5240	<a href="#">Buy on EAN</a>
General purpose relay	601390360000	60.13.9.036.0000	<a href="#">Buy on EAN</a>
11-pin;Plug-in;AgNi;3CO 10A;lockable test btton+flag indictr	601390360040	60.13.9.036.0040	<a href="#">Buy on EAN</a>
LED + diode; positive to pin 2 (60.12/60.13 coil voltages up to 125V DC only)	601390360060	60.13.9.036.0060	<a href="#">Buy on EAN</a>
Lockable test button + flag indicator + LED + diode; positive to pin 2 (60.12/60.13 coil voltages up to 125V DC only)	601390360074	60.13.9.036.0074	<a href="#">Buy on EAN</a>
General purpose relay	601390480000	60.13.9.048.0000	<a href="#">Buy on EAN</a>
Flag indicator (60.12/60.13 only)	601390480020	60.13.9.048.0020	<a href="#">Buy on EAN</a>
11-pin;Plug-in;AgNi;3CO 10A;lockable test btton+flag indictr	601390480040	60.13.9.048.0040	<a href="#">Buy on EAN</a>
11-pin;Plug-in;AgNi;3CO 10A;lockable test btton+flag indictr	601390480040PAS	60.13.9.048.0040PAS	<a href="#">Buy on EAN</a>
LED + diode; positive to pin 2 (60.12/60.13 coil voltages up to 125V DC only)	601390480060	60.13.9.048.0060	<a href="#">Buy on EAN</a>
Lockable test button + LED + diode; positive to pin 2 (60.12/60.13 coil voltages up to 125V DC only)	601390480070	60.13.9.048.0070	<a href="#">Buy on EAN</a>
Lockable test button + flag indicator + LED + diode; positive to pin 2 (60.12/60.13 coil voltages up to 125V DC only)	601390480074	60.13.9.048.0074	<a href="#">Buy on EAN</a>
Bifurcated contacts (60.12/60.13 only)	601390480240	60.13.9.048.0240	<a href="#">Buy on EAN</a>
Bifurcated contacts (60.12/60.13 only)	601390480270	60.13.9.048.0270	<a href="#">Buy on EAN</a>
AgCdO contacts (60.12/60.13 only)	601390482000	60.13.9.048.2000	<a href="#">Buy on EAN</a>
AgCdO contacts (60.12/60.13 only)	601390482040	60.13.9.048.2040	<a href="#">Buy on EAN</a>
AgCdO contacts (60.12/60.13 only)	601390482070	60.13.9.048.2070	<a href="#">Buy on EAN</a>

AgNi+Au contacts (60.12/60.13 only)	601390485000	60.13.9.048.5000	<a href="#">Buy on EAN</a>
AgNi+Au contacts (60.12/60.13 only)	601390485040	60.13.9.048.5040	<a href="#">Buy on EAN</a>
AgNi+Au contacts (60.12/60.13 only)	601390485060	60.13.9.048.5060	<a href="#">Buy on EAN</a>
AgNi+Au contacts (60.12/60.13 only)	601390485070	60.13.9.048.5070	<a href="#">Buy on EAN</a>
AgNi+Au contacts (60.12/60.13 only)	601390485074	60.13.9.048.5074	<a href="#">Buy on EAN</a>
General purpose relay	601390600000	60.13.9.060.0000	<a href="#">Buy on EAN</a>
Flag indicator (60.12/60.13 only)	601390600020	60.13.9.060.0020	<a href="#">Buy on EAN</a>
11-pin;Plug-in;AgNi;3CO 10A;lockable test btton+flag indictr	601390600040	60.13.9.060.0040	<a href="#">Buy on EAN</a>
11-pin;Plug-in;AgNi;3CO 10A;lockable test btton+flag indictr	601390600040PAS	60.13.9.060.0040PAS	<a href="#">Buy on EAN</a>
LED + diode; positive to pin 2 (60.12/60.13 coil voltages up to 125V DC only)	601390600060	60.13.9.060.0060	<a href="#">Buy on EAN</a>
Lockable test button + LED + diode; positive to pin 2 (60.12/60.13 coil voltages up to 125V DC only)	601390600070	60.13.9.060.0070	<a href="#">Buy on EAN</a>
Lockable test button + LED + diode; positive to pin 2 (60.12/60.13 coil voltages up to 125V DC only)	601390600070PAS	60.13.9.060.0070PAS	<a href="#">Buy on EAN</a>
Lockable test button + flag indicator + LED + diode; positive to pin 2 (60.12/60.13 coil voltages up to 125V DC only)	601390600074	60.13.9.060.0074	<a href="#">Buy on EAN</a>
AgCdO contacts (60.12/60.13 only)	601390602000	60.13.9.060.2000	<a href="#">Buy on EAN</a>
AgCdO contacts (60.12/60.13 only)	601390602040	60.13.9.060.2040	<a href="#">Buy on EAN</a>
AgCdO contacts (60.12/60.13 only)	601390602060	60.13.9.060.2060	<a href="#">Buy on EAN</a>
AgNi+Au contacts (60.12/60.13 only)	601390605000	60.13.9.060.5000	<a href="#">Buy on EAN</a>
AgNi+Au contacts (60.12/60.13 only)	601390605020	60.13.9.060.5020	<a href="#">Buy on EAN</a>
AgNi+Au contacts (60.12/60.13 only)	601390605040	60.13.9.060.5040	<a href="#">Buy on EAN</a>
AgNi+Au contacts (60.12/60.13 only)	601390605240	60.13.9.060.5240	<a href="#">Buy on EAN</a>
General purpose relay	601390800000	60.13.9.080.0000	<a href="#">Buy on EAN</a>
11-pin;Plug-in;AgNi;3CO 10A;lockable test btton+flag indictr	601390800040	60.13.9.080.0040	<a href="#">Buy on EAN</a>

Lockable test button + LED + diode; positive to pin 2 (60.12/60.13 coil voltages up to 125V DC only)	601390800070	60.13.9.080.0070	<a href="#">Buy on EAN</a>
General purpose relay	601391100000	60.13.9.110.0000	<a href="#">Buy on EAN</a>
Flag indicator (60.12/60.13 only)	601391100020	60.13.9.110.0020	<a href="#">Buy on EAN</a>
11-pin;Plug-in;AgNi;3CO 10A;lockable test btton+flag indictr	601391100040	60.13.9.110.0040	<a href="#">Buy on EAN</a>
11-pin;Plug-in;AgNi;3CO 10A;lockable test btton+flag indictr	601391100040PAS	60.13.9.110.0040PAS	<a href="#">Buy on EAN</a>
LED + diode; positive to pin 2 (60.12/60.13 coil voltages up to 125V DC only)	601391100060	60.13.9.110.0060	<a href="#">Buy on EAN</a>
Lockable test button + LED + diode; positive to pin 2 (60.12/60.13 coil voltages up to 125V DC only)	601391100070	60.13.9.110.0070	<a href="#">Buy on EAN</a>
Lockable test button + flag indicator + LED + diode; positive to pin 2 (60.12/60.13 coil voltages up to 125V DC only)	601391100074	60.13.9.110.0074	<a href="#">Buy on EAN</a>
AgCdO contacts (60.12/60.13 only)	601391102000	60.13.9.110.2000	<a href="#">Buy on EAN</a>
AgCdO contacts (60.12/60.13 only)	601391102040	60.13.9.110.2040	<a href="#">Buy on EAN</a>
AgCdO contacts (60.12/60.13 only)	601391102074	60.13.9.110.2074	<a href="#">Buy on EAN</a>
AgNi+Au contacts (60.12/60.13 only)	601391105000	60.13.9.110.5000	<a href="#">Buy on EAN</a>
AgNi+Au contacts (60.12/60.13 only)	601391105040	60.13.9.110.5040	<a href="#">Buy on EAN</a>
AgNi+Au contacts (60.12/60.13 only)	601391105070	60.13.9.110.5070	<a href="#">Buy on EAN</a>
AgNi+Au contacts (60.12/60.13 only)	601391105074	60.13.9.110.5074	<a href="#">Buy on EAN</a>
AgNi+Au contacts (60.12/60.13 only)	601391105240	60.13.9.110.5240	<a href="#">Buy on EAN</a>
125VDC coil (add to 1st column price)	601391250000	60.13.9.125.0000	<a href="#">Buy on EAN</a>
125VDC coil (add to 1st column price)	601391250020	60.13.9.125.0020	<a href="#">Buy on EAN</a>
125VDC coil (add to 1st column price)	601391250040	60.13.9.125.0040	<a href="#">Buy on EAN</a>
125VDC coil (add to 1st column price)	601391250040PAS	60.13.9.125.0040PAS	<a href="#">Buy on EAN</a>
125VDC coil (add to 1st column price)	601391250060	60.13.9.125.0060	<a href="#">Buy on EAN</a>
125VDC coil (add to 1st column price)	601391250070	60.13.9.125.0070	<a href="#">Buy on EAN</a>



125VDC coil (add to 1st column price)	601391250074	60.13.9.125.0074	<a href="#">Buy on EAN</a>
125VDC coil (add to 1st column price)	601391250240	60.13.9.125.0240	<a href="#">Buy on EAN</a>
125VDC coil (add to 1st column price)	601391252040	60.13.9.125.2040	<a href="#">Buy on EAN</a>
125VDC coil (add to 1st column price)	601391255040	60.13.9.125.5040	<a href="#">Buy on EAN</a>
125VDC coil (add to 1st column price)	601391255060	60.13.9.125.5060	<a href="#">Buy on EAN</a>
125VDC coil (add to 1st column price)	601391255074	60.13.9.125.5074	<a href="#">Buy on EAN</a>
140,145VDC coil (add to 1st column price)	601391400000	60.13.9.140.0000	<a href="#">Buy on EAN</a>
140,145VDC coil (add to 1st column price)	601391400040	60.13.9.140.0040	<a href="#">Buy on EAN</a>
140,145VDC coil (add to 1st column price)	601391400074	60.13.9.140.0074	<a href="#">Buy on EAN</a>
140,145VDC coil (add to 1st column price)	601391450000	60.13.9.145.0000	<a href="#">Buy on EAN</a>
140,145VDC coil (add to 1st column price)	601391450040	60.13.9.145.0040	<a href="#">Buy on EAN</a>
220VDC coil (add to 1st column price)	601392200000	60.13.9.220.0000	<a href="#">Buy on EAN</a>
220VDC coil (add to 1st column price)	601392200020	60.13.9.220.0020	<a href="#">Buy on EAN</a>
220VDC coil (add to 1st column price)	601392200040	60.13.9.220.0040	<a href="#">Buy on EAN</a>
220VDC coil (add to 1st column price)	601392200040PAS	60.13.9.220.0040PAS	<a href="#">Buy on EAN</a>
220VDC coil (add to 1st column price)	601392202040	60.13.9.220.2040	<a href="#">Buy on EAN</a>
220VDC coil (add to 1st column price)	601392205000	60.13.9.220.5000	<a href="#">Buy on EAN</a>
220VDC coil (add to 1st column price)	601392205020	60.13.9.220.5020	<a href="#">Buy on EAN</a>
220VDC coil (add to 1st column price)	601392205040	60.13.9.220.5040	<a href="#">Buy on EAN</a>
Faston 187 AgNi; 2CO 10A	603280060000	60.32.8.006.0000	<a href="#">Buy on EAN</a>
Faston 187 AgNi; 2CO 10A	603280120000	60.32.8.012.0000	<a href="#">Buy on EAN</a>
Faston 187 AgNi; 2CO 10A	603280240000	60.32.8.024.0000	<a href="#">Buy on EAN</a>
Faston 187 AgNi; 2CO 10A	603280480000	60.32.8.048.0000	<a href="#">Buy on EAN</a>
Faston 187 AgNi; 2CO 10A	603280600000	60.32.8.060.0000	<a href="#">Buy on EAN</a>

Faston 187 AgNi; 2CO 10A	603281100000	60.32.8.110.0000	<a href="#">Buy on EAN</a>
Faston 187 AgNi; 2CO 10A	603281200000	60.32.8.120.0000	<a href="#">Buy on EAN</a>
Faston 187 AgNi; 2CO 10A	603281250000	60.32.8.125.0000	<a href="#">Buy on EAN</a>
Faston 187 AgNi; 2CO 10A	603282300000	60.32.8.230.0000	<a href="#">Buy on EAN</a>
Faston 187 AgNi; 2CO 10A	603282400000	60.32.8.240.0000	<a href="#">Buy on EAN</a>
Faston 187 AgNi; 2CO 10A	603290060000	60.32.9.006.0000	<a href="#">Buy on EAN</a>
Faston 187 AgNi; 2CO 10A	603290120000	60.32.9.012.0000	<a href="#">Buy on EAN</a>
Faston 187 AgNi; 2CO 10A	603290240000	60.32.9.024.0000	<a href="#">Buy on EAN</a>
Faston 187 AgNi; 2CO 10A	603290360000	60.32.9.036.0000	<a href="#">Buy on EAN</a>
Faston 187 AgNi; 2CO 10A	603290480000	60.32.9.048.0000	<a href="#">Buy on EAN</a>
Faston 187 AgNi; 2CO 10A	603290600000	60.32.9.060.0000	<a href="#">Buy on EAN</a>
Faston 187 AgNi; 2CO 10A	603290800000	60.32.9.080.0000	<a href="#">Buy on EAN</a>
Faston 187 AgNi; 2CO 10A	603291100000	60.32.9.110.0000	<a href="#">Buy on EAN</a>
125VDC coil (add to 1st column price)	603291250000	60.32.9.125.0000	<a href="#">Buy on EAN</a>
Faston 187 AgNi; 3CO 10A	603380060000	60.33.8.006.0000	<a href="#">Buy on EAN</a>
Faston 187 AgNi; 3CO 10A	603380120000	60.33.8.012.0000	<a href="#">Buy on EAN</a>
Faston 187 AgNi; 3CO 10A	603380240000	60.33.8.024.0000	<a href="#">Buy on EAN</a>
Faston 187 AgNi; 3CO 10A	603380480000	60.33.8.048.0000	<a href="#">Buy on EAN</a>
Faston 187 AgNi; 3CO 10A	603380600000	60.33.8.060.0000	<a href="#">Buy on EAN</a>
Faston 187 AgNi; 3CO 10A	603381100000	60.33.8.110.0000	<a href="#">Buy on EAN</a>
Faston 187 AgNi; 3CO 10A	603381200000	60.33.8.120.0000	<a href="#">Buy on EAN</a>
Faston 187 AgNi; 3CO 10A	603381250000	60.33.8.125.0000	<a href="#">Buy on EAN</a>
Faston 187 AgNi; 3CO 10A	603382300000	60.33.8.230.0000	<a href="#">Buy on EAN</a>
Faston 187 AgNi; 3CO 10A	603382400000	60.33.8.240.0000	<a href="#">Buy on EAN</a>
400VAC coil; (add to 1st column price)	603384000000	60.33.8.400.0000	<a href="#">Buy on EAN</a>

Faston 187 AgNi; 3CO 10A	603390060000	60.33.9.006.0000	<a href="#">Buy on EAN</a>
Faston 187 AgNi; 3CO 10A	603390120000	60.33.9.012.0000	<a href="#">Buy on EAN</a>
Faston 187 AgNi; 3CO 10A	603390240000	60.33.9.024.0000	<a href="#">Buy on EAN</a>
Faston 187 AgNi; 3CO 10A	603390480000	60.33.9.048.0000	<a href="#">Buy on EAN</a>
Faston 187 AgNi; 3CO 10A	603390600000	60.33.9.060.0000	<a href="#">Buy on EAN</a>
Faston 187 AgNi; 3CO 10A	603390800000	60.33.9.080.0000	<a href="#">Buy on EAN</a>
Faston 187 AgNi; 3CO 10A	603391100000	60.33.9.110.0000	<a href="#">Buy on EAN</a>
125VDC coil (add to 1st column price)	603391250000	60.33.9.125.0000	<a href="#">Buy on EAN</a>
140,145VDC coil (add to 1st column price)	603391400000	60.33.9.140.0000	<a href="#">Buy on EAN</a>
220VDC coil (add to 1st column price)	603392200000	60.33.9.220.0000	<a href="#">Buy on EAN</a>
PCB mount AgNi; 2CO 10A	604280060000	60.42.8.006.0000	<a href="#">Buy on EAN</a>
PCB mount AgNi; 2CO 10A	604280120000	60.42.8.012.0000	<a href="#">Buy on EAN</a>
PCB mount AgNi; 2CO 10A	604280240000	60.42.8.024.0000	<a href="#">Buy on EAN</a>
PCB mount AgNi; 2CO 10A	604280480000	60.42.8.048.0000	<a href="#">Buy on EAN</a>
PCB mount AgNi; 2CO 10A	604280600000	60.42.8.060.0000	<a href="#">Buy on EAN</a>
PCB mount AgNi; 2CO 10A	604281100000	60.42.8.110.0000	<a href="#">Buy on EAN</a>
PCB mount AgNi; 2CO 10A	604281200000	60.42.8.120.0000	<a href="#">Buy on EAN</a>
PCB mount AgNi; 2CO 10A	604281250000	60.42.8.125.0000	<a href="#">Buy on EAN</a>
PCB mount AgNi; 2CO 10A	604282300000	60.42.8.230.0000	<a href="#">Buy on EAN</a>
PCB mount AgNi; 2CO 10A	604282400000	60.42.8.240.0000	<a href="#">Buy on EAN</a>
PCB mount AgNi; 2CO 10A	604290060000	60.42.9.006.0000	<a href="#">Buy on EAN</a>
PCB mount AgNi; 2CO 10A	604290120000	60.42.9.012.0000	<a href="#">Buy on EAN</a>
PCB mount AgNi; 2CO 10A	604290240000	60.42.9.024.0000	<a href="#">Buy on EAN</a>
PCB mount AgNi; 2CO 10A	604290480000	60.42.9.048.0000	<a href="#">Buy on EAN</a>
PCB mount AgNi; 2CO 10A	604290600000	60.42.9.060.0000	<a href="#">Buy on EAN</a>

PCB mount AgNi; 2CO 10A	604291100000	60.42.9.110.0000	<a href="#">Buy on EAN</a>
125VDC coil (add to 1st column price)	604291250000	60.42.9.125.0000	<a href="#">Buy on EAN</a>
220VDC coil (add to 1st column price)	604292200000	60.42.9.220.0000	<a href="#">Buy on EAN</a>
PCB mount AgNi; 3CO 10A	604380060000	60.43.8.006.0000	<a href="#">Buy on EAN</a>
PCB mount AgNi; 3CO 10A	604380120000	60.43.8.012.0000	<a href="#">Buy on EAN</a>
PCB mount AgNi; 3CO 10A	604380240000	60.43.8.024.0000	<a href="#">Buy on EAN</a>
PCB mount AgNi; 3CO 10A	604380480000	60.43.8.048.0000	<a href="#">Buy on EAN</a>
PCB mount AgNi; 3CO 10A	604380600000	60.43.8.060.0000	<a href="#">Buy on EAN</a>
PCB mount AgNi; 3CO 10A	604381100000	60.43.8.110.0000	<a href="#">Buy on EAN</a>
PCB mount AgNi; 3CO 10A	604381150000	60.43.8.115.0000	<a href="#">Buy on EAN</a>
PCB mount AgNi; 3CO 10A	604381200000	60.43.8.120.0000	<a href="#">Buy on EAN</a>
PCB mount AgNi; 3CO 10A	604381250000	60.43.8.125.0000	<a href="#">Buy on EAN</a>
PCB mount AgNi; 3CO 10A	604382300000	60.43.8.230.0000	<a href="#">Buy on EAN</a>
PCB mount AgNi; 3CO 10A	604382400000	60.43.8.240.0000	<a href="#">Buy on EAN</a>
PCB mount AgNi; 3CO 10A	604390060000	60.43.9.006.0000	<a href="#">Buy on EAN</a>
PCB mount AgNi; 3CO 10A	604390120000	60.43.9.012.0000	<a href="#">Buy on EAN</a>
PCB mount AgNi; 3CO 10A	604390240000	60.43.9.024.0000	<a href="#">Buy on EAN</a>
PCB mount AgNi; 3CO 10A	604390480000	60.43.9.048.0000	<a href="#">Buy on EAN</a>
PCB mount AgNi; 3CO 10A	604390600000	60.43.9.060.0000	<a href="#">Buy on EAN</a>
PCB mount AgNi; 3CO 10A	604391100000	60.43.9.110.0000	<a href="#">Buy on EAN</a>
125VDC coil (add to 1st column price)	604391250000	60.43.9.125.0000	<a href="#">Buy on EAN</a>
220VDC coil (add to 1st column price)	604392200000	60.43.9.220.0000	<a href="#">Buy on EAN</a>
Faston 187(4.8x0.8mm) rear flange mount;AgNi;2CO 10A;	606280060000	60.62.8.006.0000	<a href="#">Buy on EAN</a>
Faston 187(4.8x0.8mm) rear flange mount;AgNi;2CO 10A;	606280120000	60.62.8.012.0000	<a href="#">Buy on EAN</a>
Faston 187(4.8x0.8mm) rear flange mount;AgNi;2CO 10A;	606280240000	60.62.8.024.0000	<a href="#">Buy on EAN</a>

Faston 187(4.8x0.8mm) rear flange mount;AgNi;2CO 10A;	606280360000	60.62.8.036.0000	<a href="#">Buy on EAN</a>
Faston 187(4.8x0.8mm) rear flange mount;AgNi;2CO 10A;	606280480000	60.62.8.048.0000	<a href="#">Buy on EAN</a>
General purpose relay	606280480008	60.62.8.048.0008	<a href="#">Buy on EAN</a>
Faston 187(4.8x0.8mm) rear flange mount;AgNi;2CO 10A;	606280600000	60.62.8.060.0000	<a href="#">Buy on EAN</a>
Faston 187(4.8x0.8mm) rear flange mount;AgNi;2CO 10A;	606281100000	60.62.8.110.0000	<a href="#">Buy on EAN</a>
Faston 187(4.8x0.8mm) rear flange mount;AgNi;2CO 10A;	606281200000	60.62.8.120.0000	<a href="#">Buy on EAN</a>
Faston 187(4.8x0.8mm) rear flange mount;AgNi;2CO 10A;	606281250000	60.62.8.125.0000	<a href="#">Buy on EAN</a>
Faston 187(4.8x0.8mm) rear flange mount;AgNi;2CO 10A;	606282300000	60.62.8.230.0000	<a href="#">Buy on EAN</a>
Faston 187(4.8x0.8mm) rear flange mount;AgNi;2CO 10A;	606282400000	60.62.8.240.0000	<a href="#">Buy on EAN</a>
400VAC coil; (add to 1st column price)	606284000000	60.62.8.400.0000	<a href="#">Buy on EAN</a>
Faston 187(4.8x0.8mm) rear flange mount;AgNi;2CO 10A;	606290060000	60.62.9.006.0000	<a href="#">Buy on EAN</a>
Faston 187(4.8x0.8mm) rear flange mount;AgNi;2CO 10A;	606290120000	60.62.9.012.0000	<a href="#">Buy on EAN</a>
Faston 187(4.8x0.8mm) rear flange mount;AgNi;2CO 10A;	606290240000	60.62.9.024.0000	<a href="#">Buy on EAN</a>
Faston 187(4.8x0.8mm) rear flange mount;AgNi;2CO 10A;	606290360000	60.62.9.036.0000	<a href="#">Buy on EAN</a>
Faston 187(4.8x0.8mm) rear flange mount;AgNi;2CO 10A;	606290480000	60.62.9.048.0000	<a href="#">Buy on EAN</a>
Faston 187(4.8x0.8mm) rear flange mount;AgNi;2CO 10A;	606290600000	60.62.9.060.0000	<a href="#">Buy on EAN</a>
Faston 187(4.8x0.8mm) rear flange mount;AgNi;2CO 10A;	606291100000	60.62.9.110.0000	<a href="#">Buy on EAN</a>
125VDC coil (add to 1st column price)	606291250000	60.62.9.125.0000	<a href="#">Buy on EAN</a>
Faston 187(4.8x0.8mm) rear flange mount;AgNi;3CO 10A;	606380060000	60.63.8.006.0000	<a href="#">Buy on EAN</a>
Faston 187(4.8x0.8mm) rear flange mount;AgNi;3CO 10A;	606380120000	60.63.8.012.0000	<a href="#">Buy on EAN</a>
Faston 187(4.8x0.8mm) rear flange mount;AgNi;3CO 10A;	606380240000	60.63.8.024.0000	<a href="#">Buy on EAN</a>
Faston 187(4.8x0.8mm) rear flange mount;AgNi;3CO 10A;	606380360000	60.63.8.036.0000	<a href="#">Buy on EAN</a>
Faston 187(4.8x0.8mm) rear flange mount;AgNi;3CO 10A;	606380480000	60.63.8.048.0000	<a href="#">Buy on EAN</a>

Faston 187(4.8x0.8mm) rear flange mount;AgNi;3CO 10A;	606380600000	60.63.8.060.0000	<a href="#">Buy on EAN</a>
Faston 187(4.8x0.8mm) rear flange mount;AgNi;3CO 10A;	606381100000	60.63.8.110.0000	<a href="#">Buy on EAN</a>
Faston 187(4.8x0.8mm) rear flange mount;AgNi;3CO 10A;	606381150000	60.63.8.115.0000	<a href="#">Buy on EAN</a>
Faston 187(4.8x0.8mm) rear flange mount;AgNi;3CO 10A;	606381200000	60.63.8.120.0000	<a href="#">Buy on EAN</a>
Faston 187(4.8x0.8mm) rear flange mount;AgNi;3CO 10A;	606381250000	60.63.8.125.0000	<a href="#">Buy on EAN</a>
Faston 187(4.8x0.8mm) rear flange mount;AgNi;3CO 10A;	606382300000	60.63.8.230.0000	<a href="#">Buy on EAN</a>
Faston 187(4.8x0.8mm) rear flange mount;AgNi;3CO 10A;	606382400000	60.63.8.240.0000	<a href="#">Buy on EAN</a>
400VAC coil; (add to 1st column price)	606384000000	60.63.8.400.0000	<a href="#">Buy on EAN</a>
Faston 187(4.8x0.8mm) rear flange mount;AgNi;3CO 10A;	606390060000	60.63.9.006.0000	<a href="#">Buy on EAN</a>
Faston 187(4.8x0.8mm) rear flange mount;AgNi;3CO 10A;	606390120000	60.63.9.012.0000	<a href="#">Buy on EAN</a>
Faston 187(4.8x0.8mm) rear flange mount;AgNi;3CO 10A;	606390240000	60.63.9.024.0000	<a href="#">Buy on EAN</a>
Faston 187(4.8x0.8mm) rear flange mount;AgNi;3CO 10A;	606390360000	60.63.9.036.0000	<a href="#">Buy on EAN</a>
Faston 187(4.8x0.8mm) rear flange mount;AgNi;3CO 10A;	606390480000	60.63.9.048.0000	<a href="#">Buy on EAN</a>
Faston 187(4.8x0.8mm) rear flange mount;AgNi;3CO 10A;	606390600000	60.63.9.060.0000	<a href="#">Buy on EAN</a>
Faston 187(4.8x0.8mm) rear flange mount;AgNi;3CO 10A;	606391100000	60.63.9.110.0000	<a href="#">Buy on EAN</a>
125VDC coil (add to 1st column price)	606391250000	60.63.9.125.0000	<a href="#">Buy on EAN</a>
220VDC coil (add to 1st column price)	606392200000	60.63.9.220.0000	<a href="#">Buy on EAN</a>